

NO.	DATE	DESCRIPTION
1	05/09/22	First Submittal
fp	BY	
1	SUB	

EVINS GLASS SERVICE, INC
 101 N.P.I.D., CORPUS CHRISTI, TX 78406
 WORK (361) 884-3995 FAX (361) 884-4262

PROJECT: ART MUSEUM OF SOUTH TEXAS
RENOVATION IMPROVEMENTS
 ARCHITECT: HANSON PROFESSIONAL SERVICES, INC
 (361) 914-9800
 GENERAL CONTRACTOR: SOUTH TEXAS BUILDING PARTNERS
 (361) 298-5462

PROJECT NO.	EGS-2204-05
DRAWN BY	fp
DATE	05/09/22
SCALE	NTS
DRAWING	FLOOR PLANS
SHEET	P1

RESTAURANT STOREFRONT DIMENSIONS

- 1R - 13'-2" X 8'-0", W/ SINGLE 3'-0" DOOR (RH)
- 2R - 22'-9" X 8'-0"
- 3R - 12'-9" X 8'-0", W/ SINGLE 3'-0" DOOR (LH)
- 4R - 26'-0" X 8'-0", W/ SINGLE 3'-0" DOOR (LH)
- 6R - 13'-0 1/2" X 8'-0"
- 7RA & 7RB - 7'-11 1/2" X 8'-0 3/4" ABOVE, & 8'-0" X 8'-0" BELOW
- 8R - 4'-0 1/2" X 8'-0"

MUSEUM STOREFRONT DIMENSIONS

- 1M - 33'-0" X 12'-0", W/ DOUBLE 3'-0" DOORS
- 6M - REPAIR ONLY, 10'-0" X 10'-0", W/ DOUBLE 3'-0" DOORS [BASEMENT]
- 9M - 3'-0" X 7'-0" DOOR ON FRAME (LH) [SECOND FLOOR]
- 10M - 12'-0" X 9'-6"
- 11MA - 12'-0" X 9'-6"
- 11MB - 12'-0" X 9'-6"
- 12M - 8'-3" X 9'-6"
- 13M - 2'-0" X 9'-0"
- 14M - 5'-0" X 7'-2 1/2", W/ SINGLE 3'-0" DOOR (LH) [SECOND FLOOR]
- 16M - A DOUBLE 3'-0" X 7'-0" DOOR AND FRAME
- 1LH - 20'-0" X 8'-0", W/ DOUBLE 3'-0" DOORS

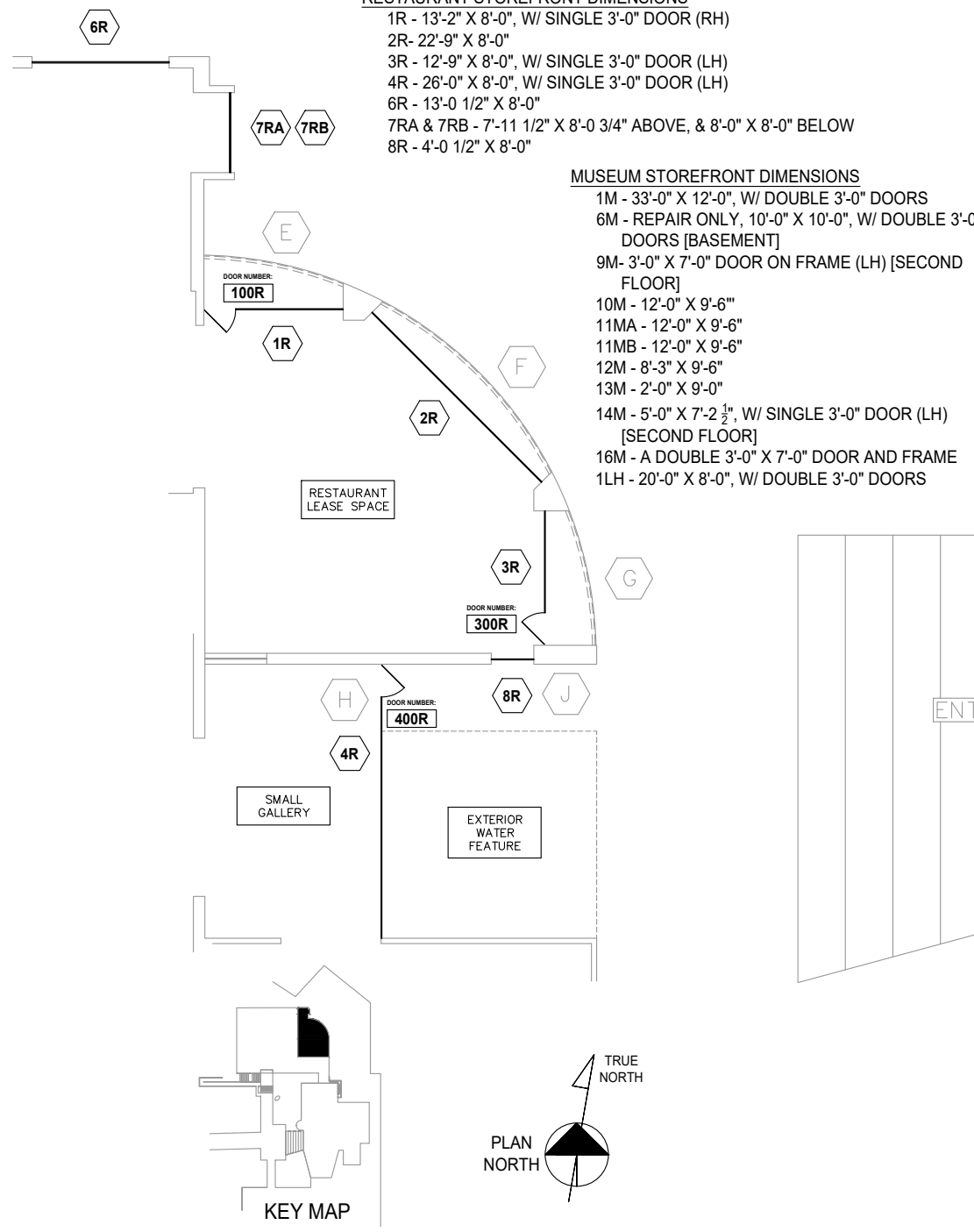

FLOOR PLAN

SCALE: NTS
 ARCH REF: 1/SH4

1 RESTAURANT FLOOR PLAN
 KAWNEER IR-501 IMPACT ALUMINUM STOREFRONT
 KAWNEER 500-IR IMPACT DOORS ON IR-501 FRAME

FLOOR PLAN

SCALE: NTS
 ARCH REF: 1/SH6

2 MUSEUM FIRST FLOOR PLAN
 KAWNEER IR-501 IMPACT ALUMINUM STOREFRONT
 KAWNEER 500-IR IMPACT DOORS ON IR-501 FRAME
 KAWNEER 1600, SYSTEM 1, CURTAIN WALL
 KAWNEER 500 IR IMPACT DOORS ON 1600, SYSTEM 1, CURTAIN WALL

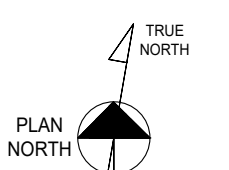
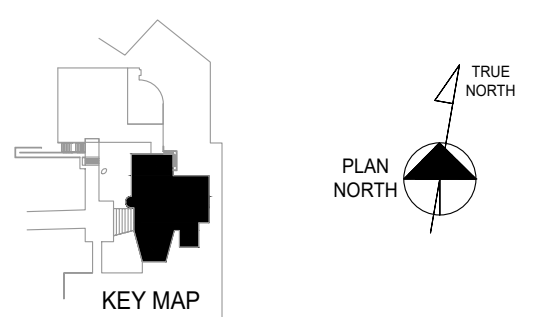
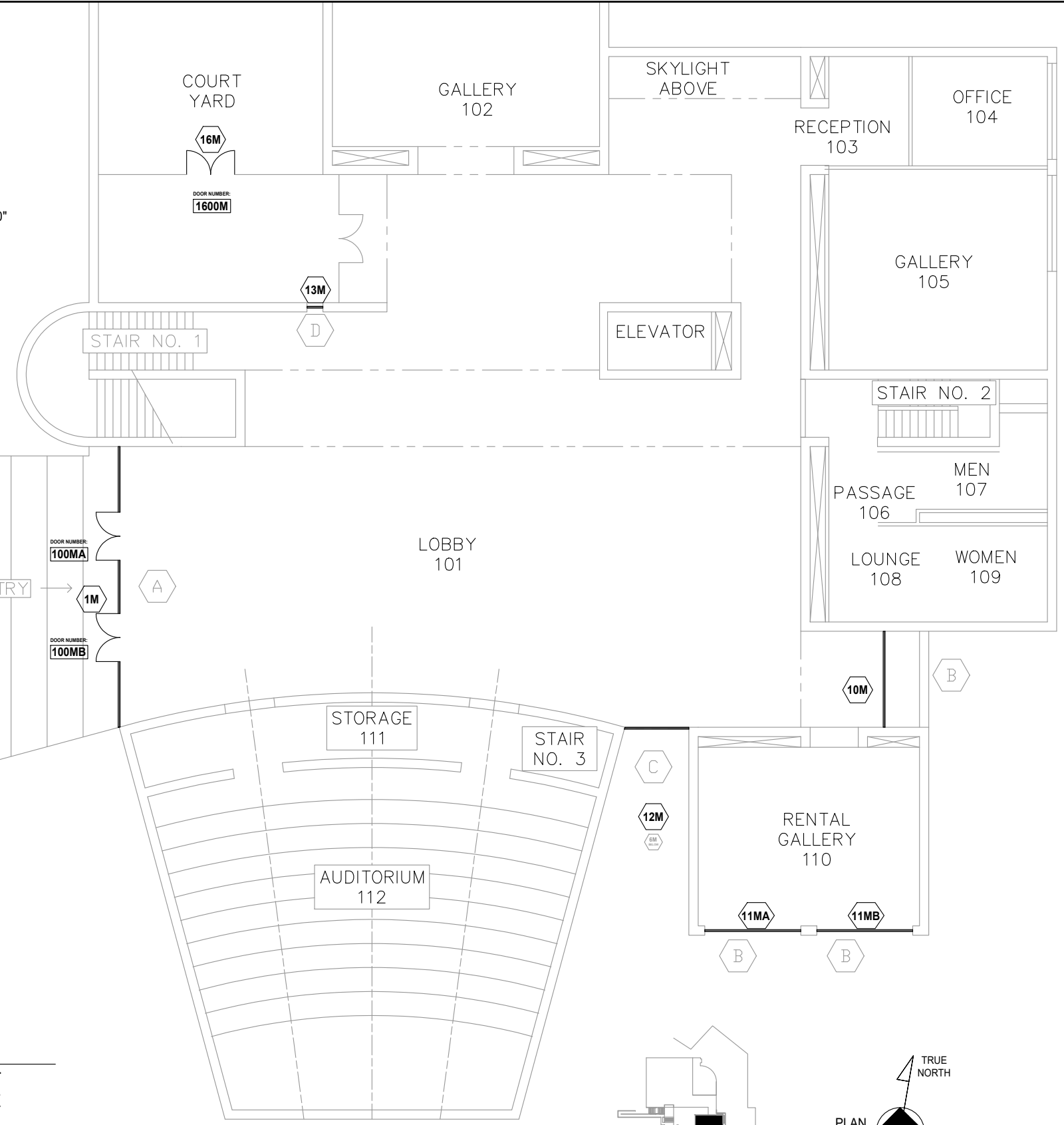

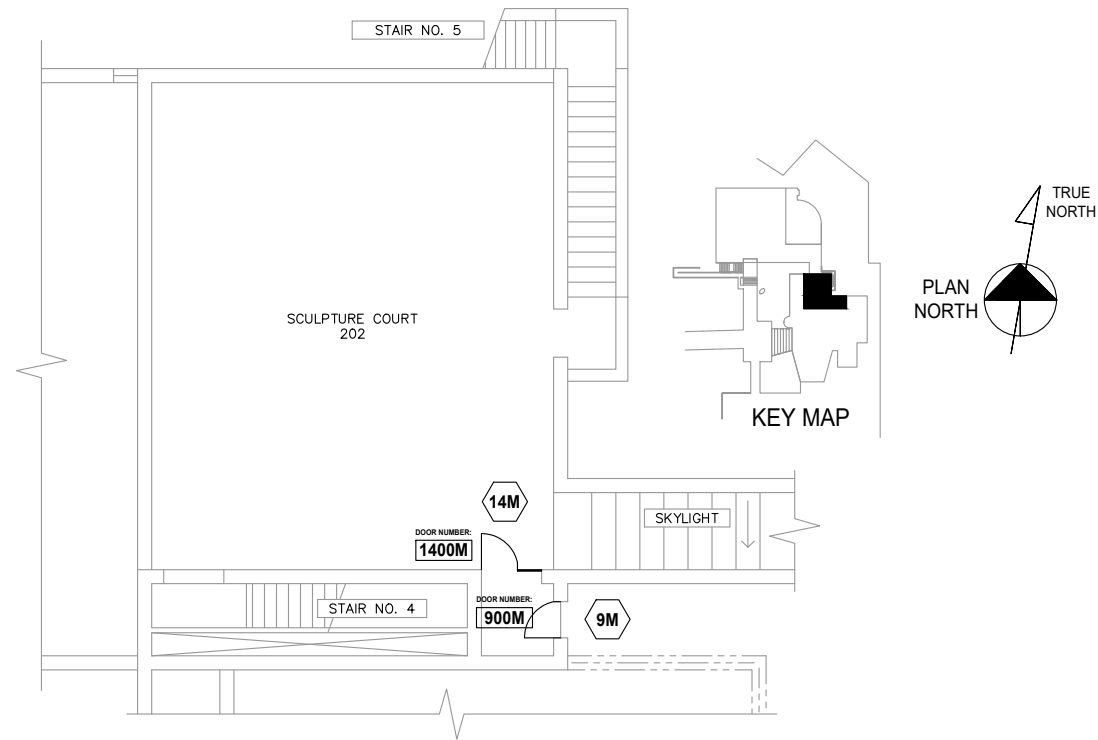

FLOOR PLAN 3 MUSEUM SECOND FLOOR PLAN
 SCALE: NTS
 ARCH REF: 4/SH6
 KAWNEER IR-501 IMPACT ALUMINUM STOREFRONT
 KAWNEER 500-IIR IMPACT DOORS ON IR-501 FRAME

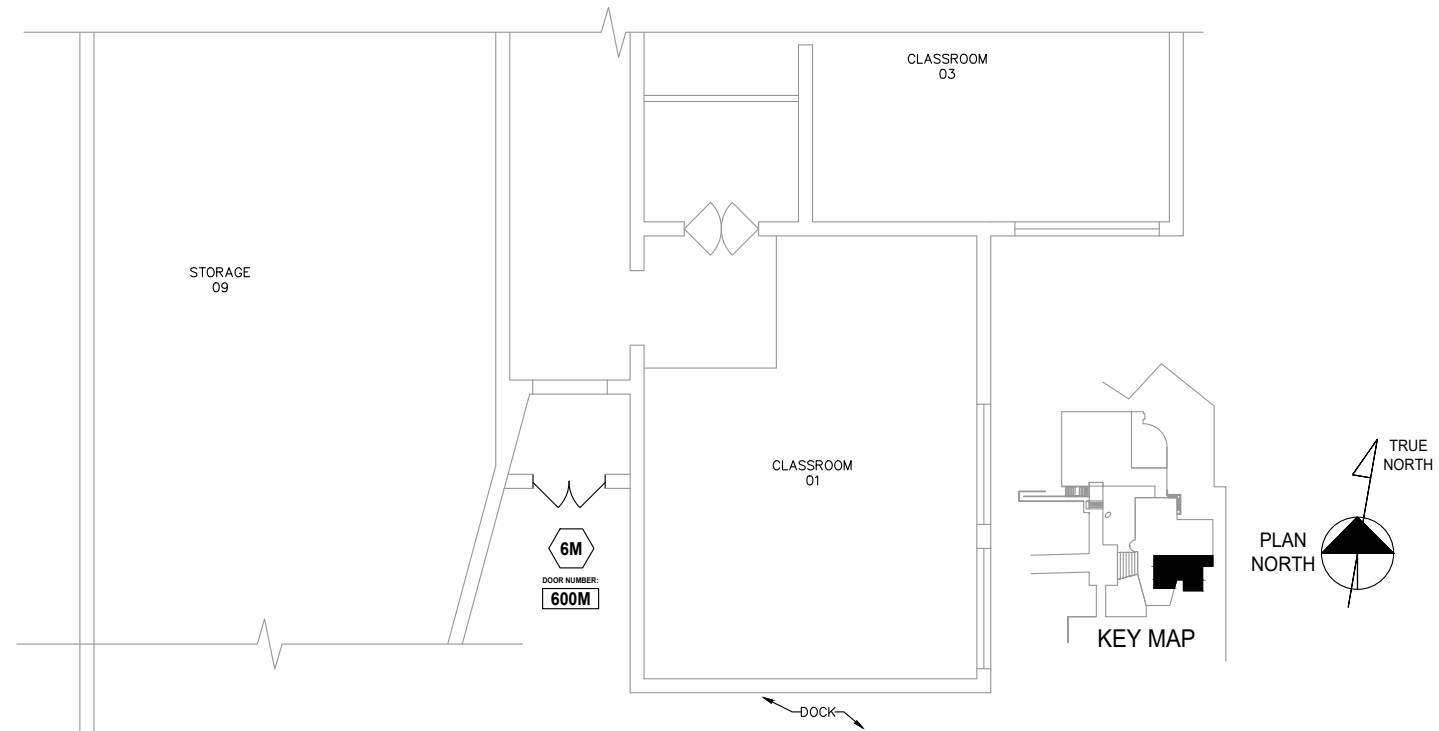

FLOOR PLAN 5 MUSEUM BASEMENT FLOOR PLAN
 SCALE: NTS
 ARCH REF: 3/SH6
 REPAIR EXISTING DOOR

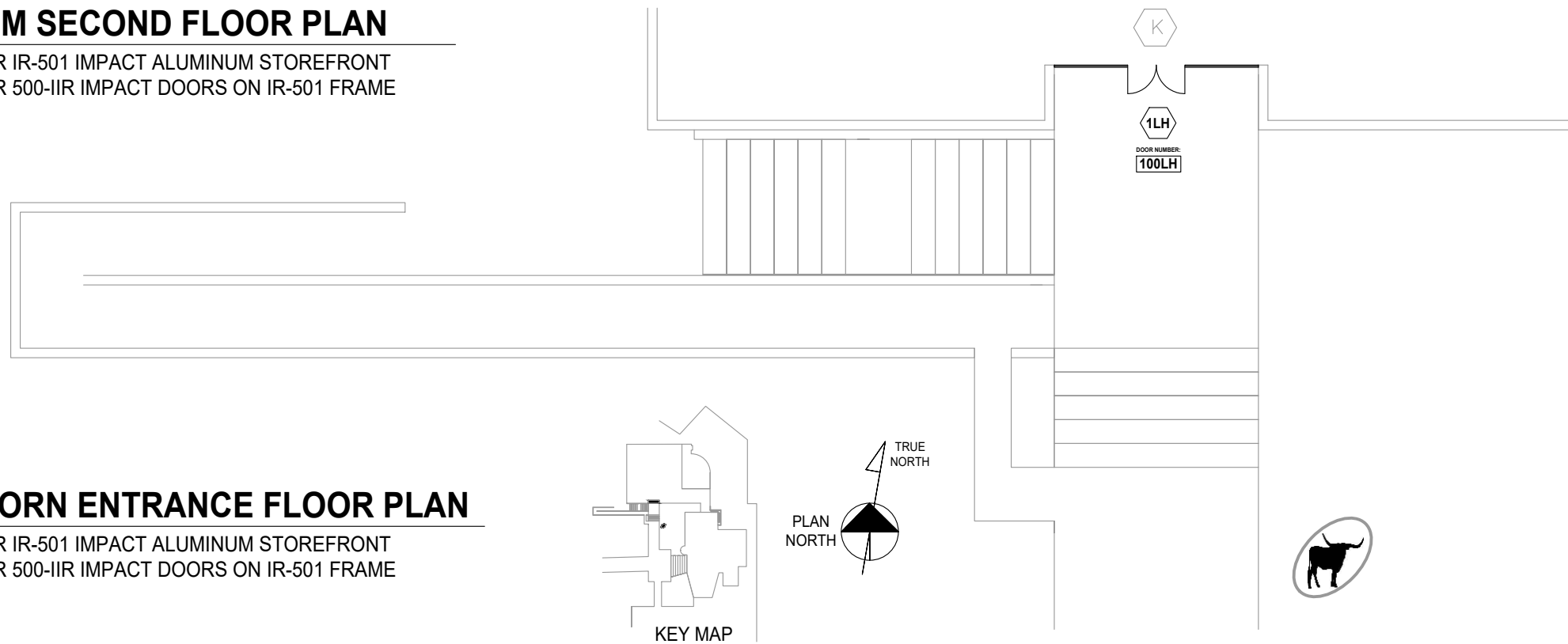

FLOOR PLAN 4 LONGHORN ENTRANCE FLOOR PLAN
 SCALE: NTS
 ARCH REF: 1/SH9
 KAWNEER IR-501 IMPACT ALUMINUM STOREFRONT
 KAWNEER 500-IIR IMPACT DOORS ON IR-501 FRAME

NO.	DATE	DESCRIPTION
1	05/09/22	First Submittal
fp	BY	
1	SUB	

EVINS GLASS SERVICE, INC
 101 N.P.I.D., CORPUS CHRISTI, TX 78406
 WORK (361) 884-3995 FAX (361) 884-4262

PROJECT: ART MUSEUM OF SOUTH TEXAS
RENOVATION IMPROVEMENTS
 ARCHITECT: HANSON PROFESSIONAL SERVICES, INC
 (361) 914-9800
 GENERAL CONTRACTOR: SOUTH TEXAS BUILDING PARTNERS
 (361) 298-5462

PROJECT NO.	EGS-2204-05
DRAWN BY	fp
DATE	05/09/22
SCALE	NTS
DRAWING	FLOOR PLANS
SHEET	P1

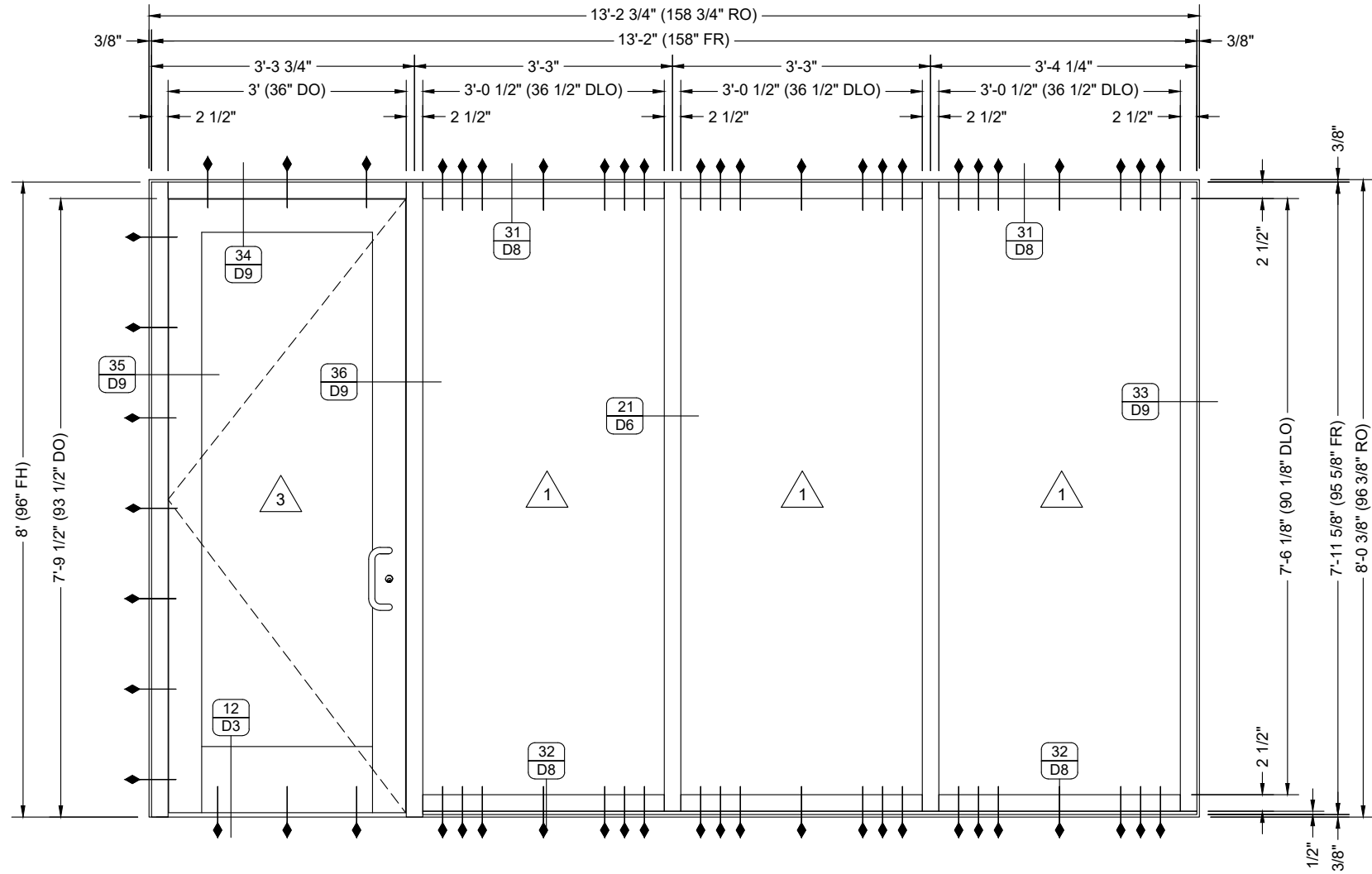

DOOR HARDWARE

- HINGES: 4 DOOR HINGES PER DOOR, KAWNEER PART NO. 037-232
- CLOSER: LCN 4040XP, GRADE 1, DARK BRONZE FINISH (695 WITH METAL COVER (OPTION-MC), MOUNTING PLATE- 404X0-18G, AND LONG ARM (OPTION - LONG)
- PANIC HARDWARE: KAWNEER 1686 CVR, CONCEALED VERT. ROD DEVICE, FINISH IN DARK BRONZE (710), WITH TOP STRIKE -338 AND BOTTOM STRIKE -358A
 - a. LEFT LEAF TO HAVE FUNCTION - NLOP (NIGHT LATCH, LESS PULL) WITH 392-7 OFFSET PULL
 - b. RIGHT LEAF TO HAVE FUNCTION - EO (EXIT ONLY) WITH 392-7 OFFSET PULL
 - a.a. NOTE: PANIC HARDWARE CAN BE DOGGED (LOCKED DOWN IN THE OPEN POSITION) FROM THE INSIDE TO ALLOW FREE PASSAGE DURING OPERATING HOURS
- THRESHOLD: KAWNEER PART NO. 069-139, ALUMINUM
- BOTTOM RAIL WEATHER STRIP: KAWNEER PART NO. 200-795
- ASTRAGAL WEATHER GASKET - PER DOOR MANUFACTURER

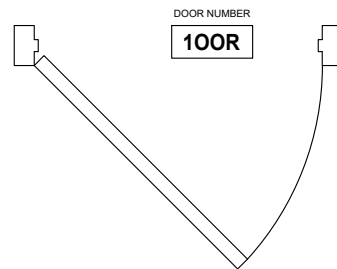

ELEVATION

QUANTITY: 01
 SCALE: 1/2" = 1'-0"
 ARCH REF: 1/SH4
 2/SH4
 1/SH12

1R

EXT STOREFRONT

KAWNEER IR-501 IMPACT ALUMINUM STOREFRONT
 KAWNEER 500-IR IMPACT DOORS ON IR-501 FRAMING

TYPE "E"

NO.	DATE	BY	DESCRIPTION
1	05/09/22	fp	First Submittal

EVINS GLASS SERVICE, INC
 101 N.P.I.D., CORPUS CHRISTI, TX 78406
 WORK (361) 884-3995 FAX (361) 884-4262

PROJECT: ART MUSEUM OF SOUTH TEXAS
RENOVATION IMPROVEMENTS
 ARCHITECT: HANSON PROFESSIONAL SERVICES, INC
 (361) 914-9800
 GENERAL CONTRACTOR: SOUTH TEXAS BUILDING PARTNERS
 (361) 298-5462

PROJECT NO.	EGS-2204-05
DRAWN BY	fp
DATE	05/09/22
SCALE	1/2" = 1'-0"
DRAWING	ELEVATIONS
SHEET	E1

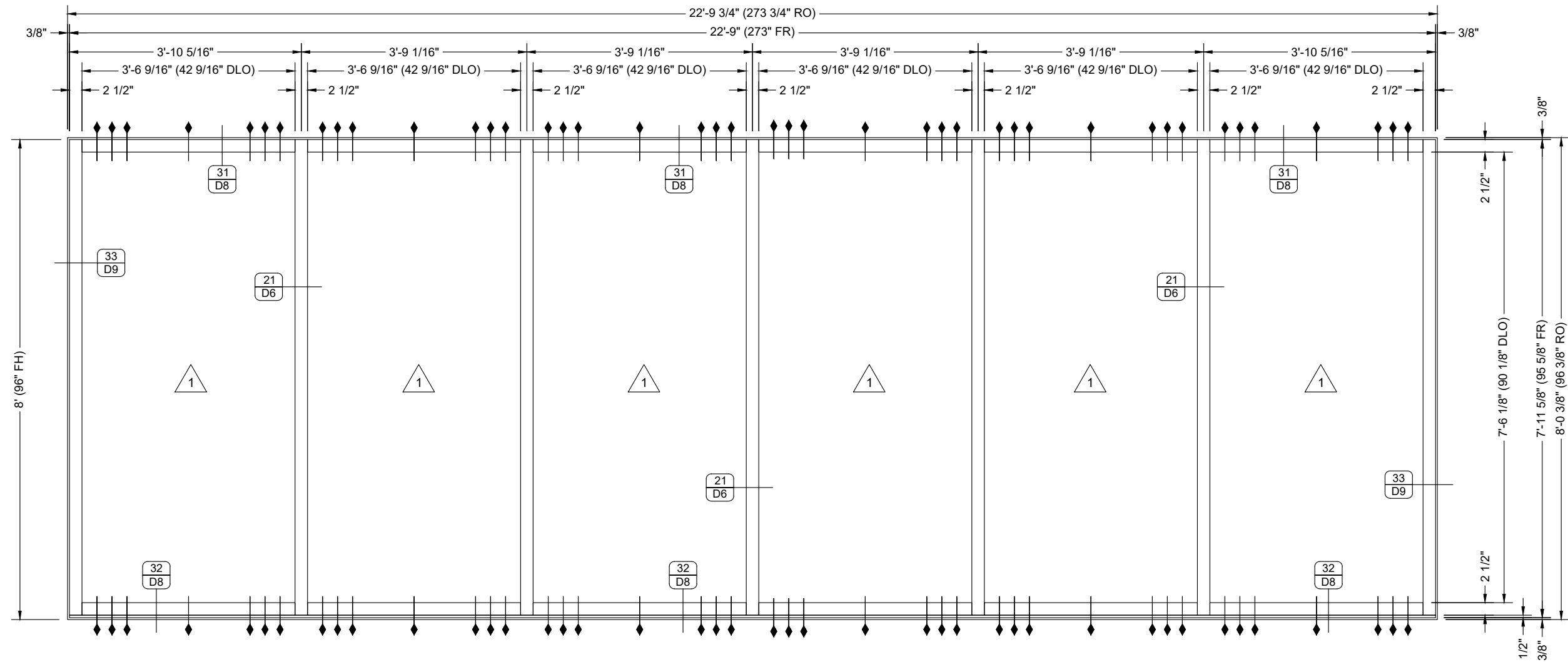

ELEVATION

QUANTITY: 01
 SCALE: 1/2" = 1'-0"
 ARCH REF: 1/SH4
 3/SH4
 2/SH12

2R

EXT STOREFRONT

KAWNEER IR-501 IMPACT ALUMINUM STOREFRONT

TYPE
"F"

NO.	DATE	BY	DESCRIPTION
1	05/09/22	fp	First Submittal

EVINS GLASS SERVICE, INC
 101 N.P.I.D., CORPUS CHRISTI, TX 78406
 WORK (361) 884-3995 FAX (361) 884-4262

PROJECT: ART MUSEUM OF SOUTH TEXAS
RENOVATION IMPROVEMENTS
 ARCHITECT: HANSON PROFESSIONAL SERVICES, INC
 (361) 914-9800
 GENERAL CONTRACTOR: SOUTH TEXAS BUILDING PARTNERS
 (889) 298-5462

PROJECT NO.	EGS-2204-05
DRAWN BY	fp
DATE	05/09/22
SCALE	1/2" = 1'-0"
DRAWING	ELEVATIONS
SHEET	E2

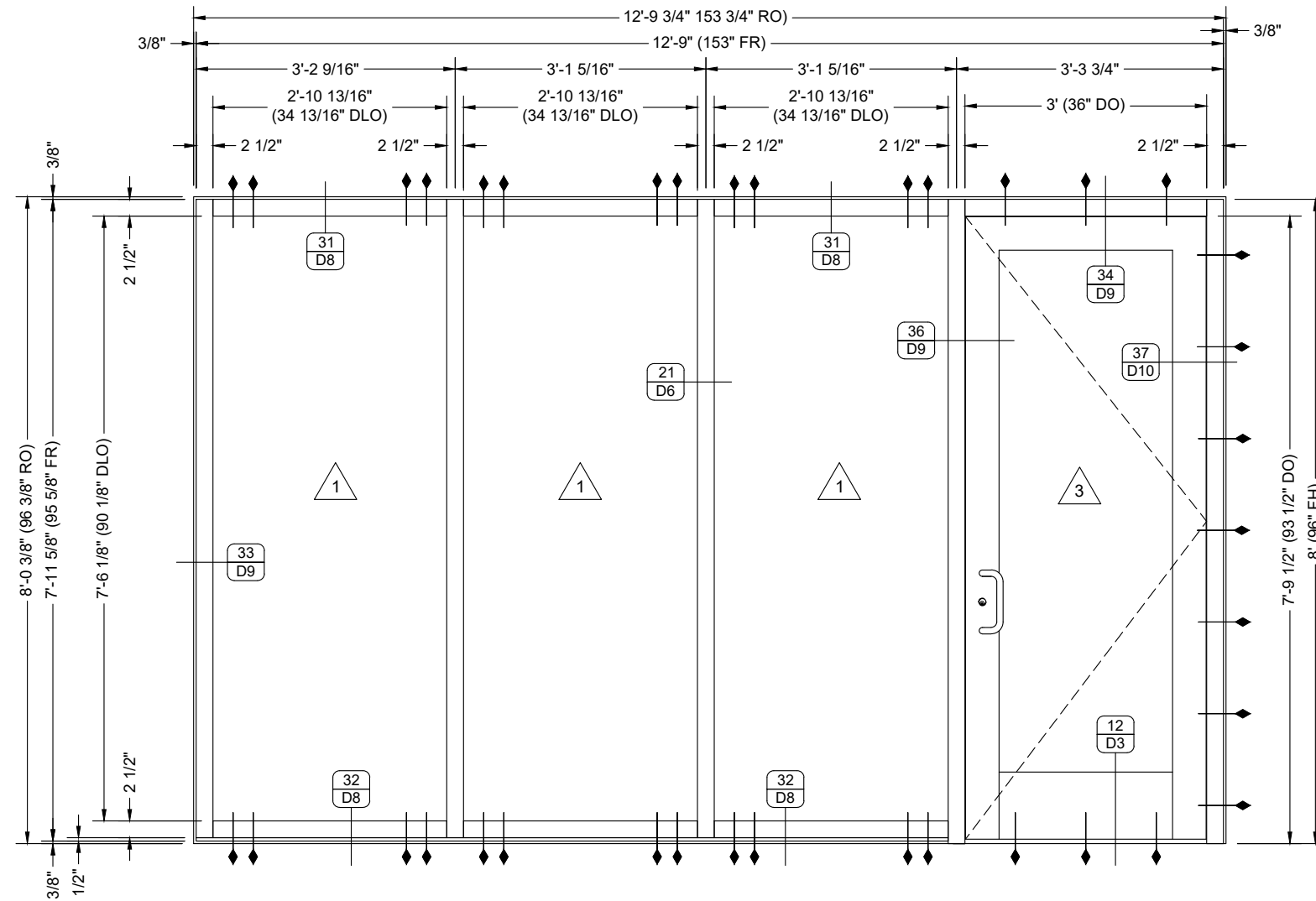

ELEVATION

QUANTITY: 01
 SCALE: 1/2" = 1'-0"
 ARCH REF: 1/SH4
 4/SH4
 3/SH12



3R EXT STOREFRONT TYPE "G"

KAWNEER IR-501 IMPACT ALUMINUM STOREFRONT
 KAWNEER 500-IR IMPACT DOORS ON IR-501 FRAMING

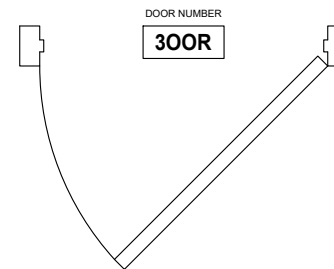

DOOR HARDWARE

HINGES: 4 DOOR HINGES PER DOOR, KAWNEER PART NO. 037-232
 CLOSER: LCN 4040XP, GRADE 1, DARK BRONZE FINISH (695 WITH METAL COVER (OPTION-MC), MOUNTING PLATE- 404X0-18G, AND LONG ARM (OPTION - LONG)
 PANIC HARDWARE: KAWNEER 1686 CVR, CONCEALED VERT. ROD DEVICE, FINISH IN DARK BRONZE (710), WITH TOP STRIKE -338 AND BOTTOM STRIKE -358A
 a. LEFT LEAF TO HAVE FUNCTION - NLOP (NIGHT LATCH, LESS PULL) WITH 392-7 OFFSET PULL
 b. RIGHT LEAF TO HAVE FUNCTION - EO (EXIT ONLY) WITH 392-7 OFFSET PULL
 a.a. NOTE: PANIC HARDWARE CAN BE DOGGED (LOCKED DOWN IN THE OPEN POSITION) FROM THE INSIDE TO ALLOW FREE PASSAGE DURING OPERATING HOURS
 THRESHOLD: KAWNEER PART NO. 069-139, ALUMINUM
 BOTTOM RAIL WEATHER STRIP: KAWNEER PART NO. 200-795
 ASTRAGAL WEATHER GASKET - PER DOOR MANUFACTURER

DATE	DESCRIPTION
05/09/22	First Submittal
fp	BY
1	SUB

EVINS GLASS SERVICE, INC
 101 N.P.I.D., CORPUS CHRISTI, TX 78406
 WORK (361) 884-3995 FAX (361) 884-4262

PROJECT: ART MUSEUM OF SOUTH TEXAS
RENOVATION IMPROVEMENTS
 ARCHITECT: HANSON PROFESSIONAL SERVICES, INC
 (361) 914-9800
 GENERAL CONTRACTOR: SOUTH TEXAS BUILDING PARTNERS
 (889) 298-6462

PROJECT NO. EGS-2204-05	
DRAWN BY fp	DATE 05/09/22
SCALE 1/2" = 1'-0"	
DRAWING ELEVATIONS	
SHEET E3	

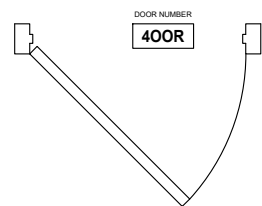
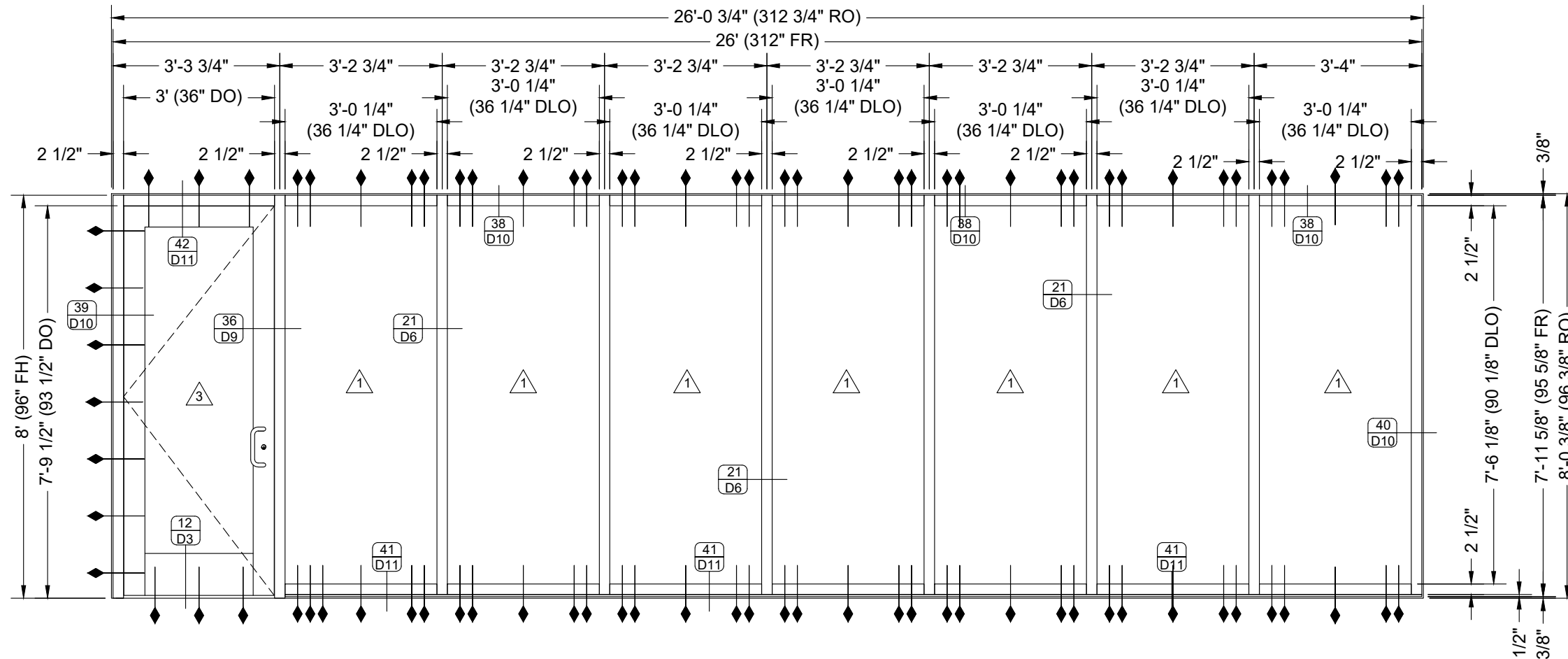

DOOR HARDWARE

HINGES: 4 DOOR HINGES PER DOOR, KAWNEER PART NO. 037-232
 CLOSER: LCN 4040XP, GRADE 1, DARK BRONZE FINISH (695 WITH METAL COVER (OPTION-MC), MOUNTING PLATE- 4040X-18G, AND LONG ARM (OPTION - LONG)
 PANIC HARDWARE: VON DUPRIN 9947, CONCEALED VERT. ROD DEVICE, FINISH IN DARK BRONZE (710), WITH TOP STRIKE -338 AND BOTTOM STRIKE -358A
 a. LEFT LEAF TO HAVE FUNCTION - NLOP (NIGHT LATCH, LESS PULL) WITH 392-7 OFFSET PULL
 b. RIGHT LEAF TO HAVE FUNCTION - EO (EXIT ONLY) WITH 392-7 OFFSET PULL
 a.a. NOTE: PANIC HARDWARE CAN BE DOGGED (LOCKED DOWN IN THE OPEN POSITION) FROM THE INSIDE TO ALLOW FREE PASSAGE DURING OPERATING HOURS
 THRESHOLD: KAWNEER PART NO. 069-139, ALUMINUM
 BOTTOM RAIL WEATHER STRIP: KAWNEER PART NO. 200-795
 ASTRAGAL WEATHER GASKET - PER DOOR MANUFACTURER

ELEVATION

QUANTITY: 01
 SCALE: 3/8" = 1'-0"
 ARCH REF: 1/SH4
 5/SH4
 4/SH12

4R

EXT STOREFRONT

TYPE "H"

KAWNEER IR-501 IMPACT ALUMINUM STOREFRONT
 KAWNEER 500-IR IMPACT DOORS ON IR-501 FRAME

NO.	DATE	DESCRIPTION
1	05/09/22	First Submittal

EVINS GLASS SERVICE, INC
 101 N.P.I.D., CORPUS CHRISTI, TX 78406
 WORK (361) 884-3995 FAX (361) 884-4262

PROJECT: ART MUSEUM OF SOUTH TEXAS
RENOVATION IMPROVEMENTS
 ARCHITECT: HANSON PROFESSIONAL SERVICES, INC
 (361) 914-9800
 GENERAL CONTRACTOR: SOUTH TEXAS BUILDING PARTNERS
 (361) 298-5462

PROJECT NO.	EGS-2204-05
DRAWN BY	fp
DATE	05/09/22
SCALE	3/8" = 1'-0"
DRAWING	ELEVATIONS
SHEET	E4

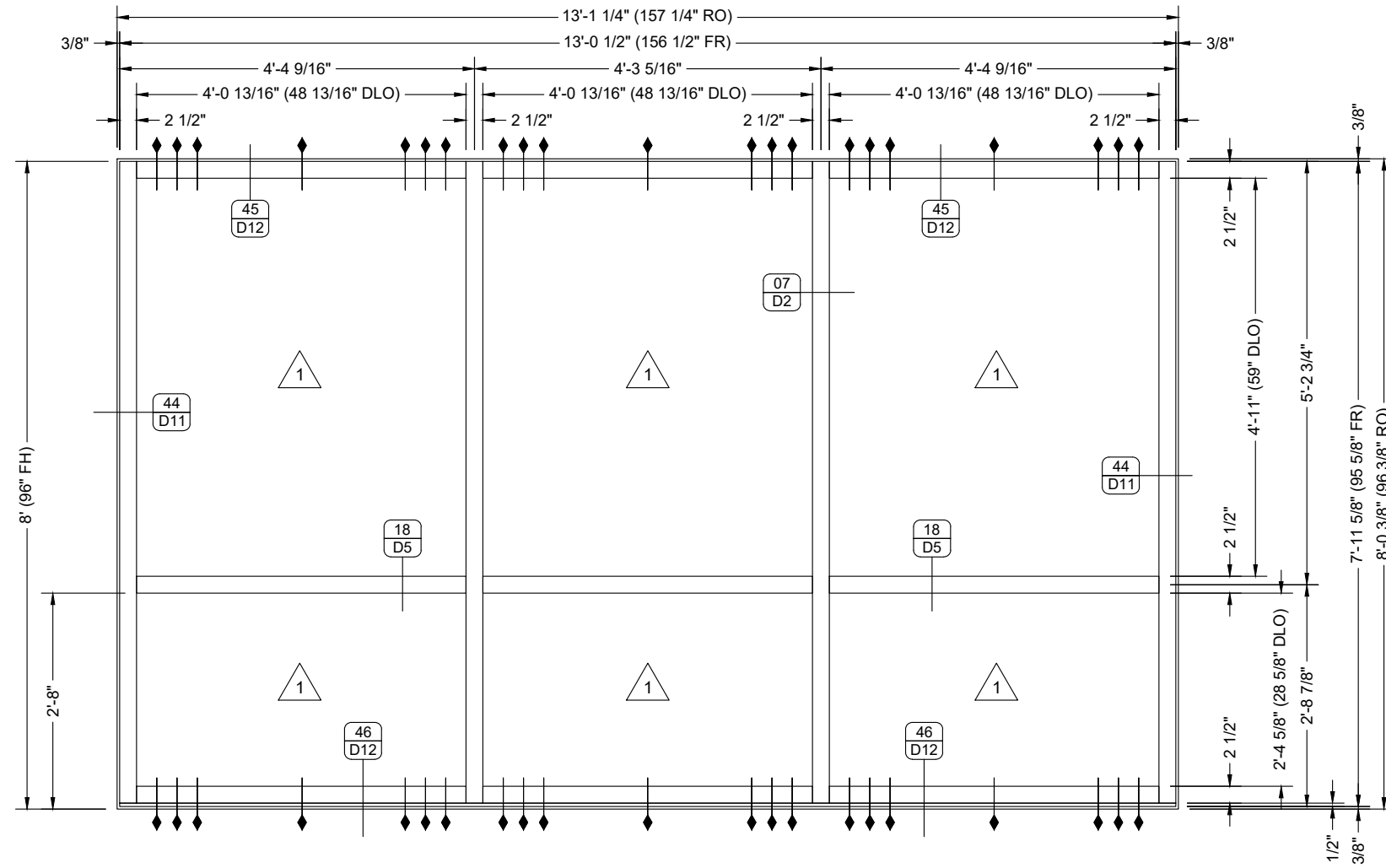

ELEVATION

QUANTITY: 01
 SCALE: 1/2" = 1'-0"
 ARCH REF: 1/SH4
 1/SH5
 2/SH5



6R EXT STOREFRONT

KAWNEER IR-501 IMPACT ALUMINUM STOREFRONT

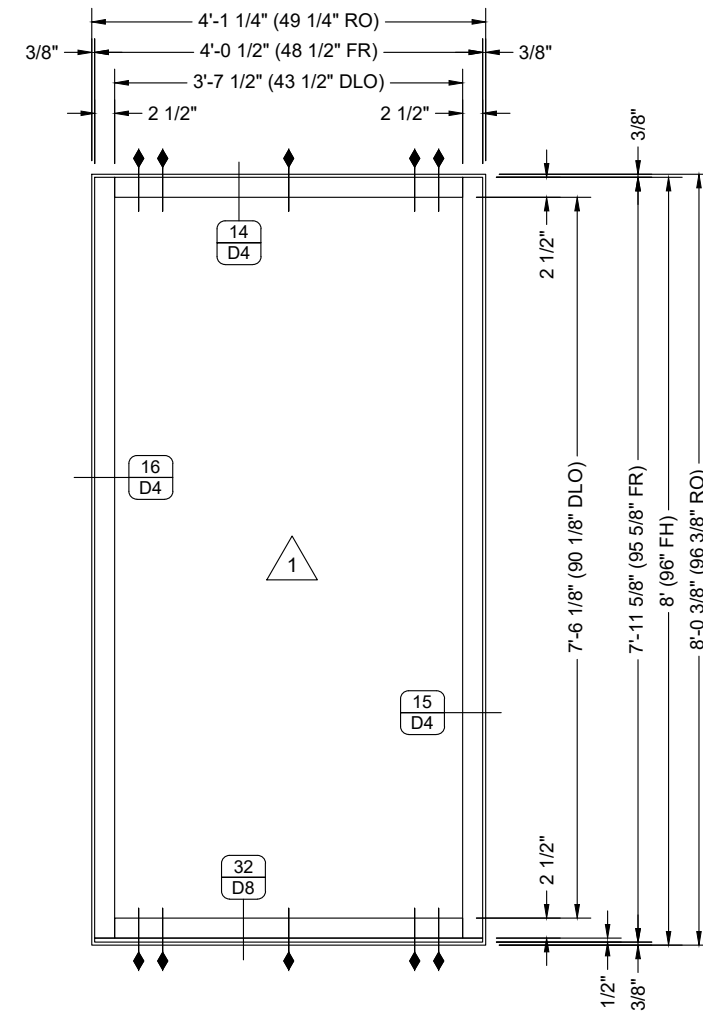

ELEVATION

QUANTITY: 01
 SCALE: 1/2" = 1'-0"
 ARCH REF: 1/SH4
 5/SH5
 5/SH12



8R EXT STOREFRONT TYPE "J"

KAWNEER IR-501 IMPACT ALUMINUM STOREFRONT
 KAWNEER 500-IR IMPACT DOORS ON IR-501 FRAMING

PROJECT	DESCRIPTION
ART MUSEUM OF SOUTH TEXAS	
RENOVATION IMPROVEMENTS	
ARCHITECT	
HANSON PROFESSIONAL SERVICES, INC	
(361) 914-9800	
GENERAL CONTRACTOR	
SOUTH TEXAS BUILDING PARTNERS	
(891) 298-5462	
PROJECT NO.	
EGS-2204-05	
DRAWN BY	DATE
fp	05/09/22
SCALE	
1/2" = 1'-0"	
DRAWING	
ELEVATIONS	
SHEET	
E5	

EVINS GLASS SERVICE, INC
 101 N.P.I.D., CORPUS CHRISTI, TX 78406
 WORK (361) 884-3995 FAX (361) 884-4262

PROJECT
 ART MUSEUM OF SOUTH TEXAS
RENOVATION IMPROVEMENTS
 ARCHITECT
 HANSON PROFESSIONAL SERVICES, INC
 (361) 914-9800
 GENERAL CONTRACTOR
 SOUTH TEXAS BUILDING PARTNERS
 (891) 298-5462

PROJECT NO.	EGS-2204-05
DRAWN BY	DATE
fp	05/09/22
SCALE	1/2" = 1'-0"
DRAWING	ELEVATIONS
SHEET	E5

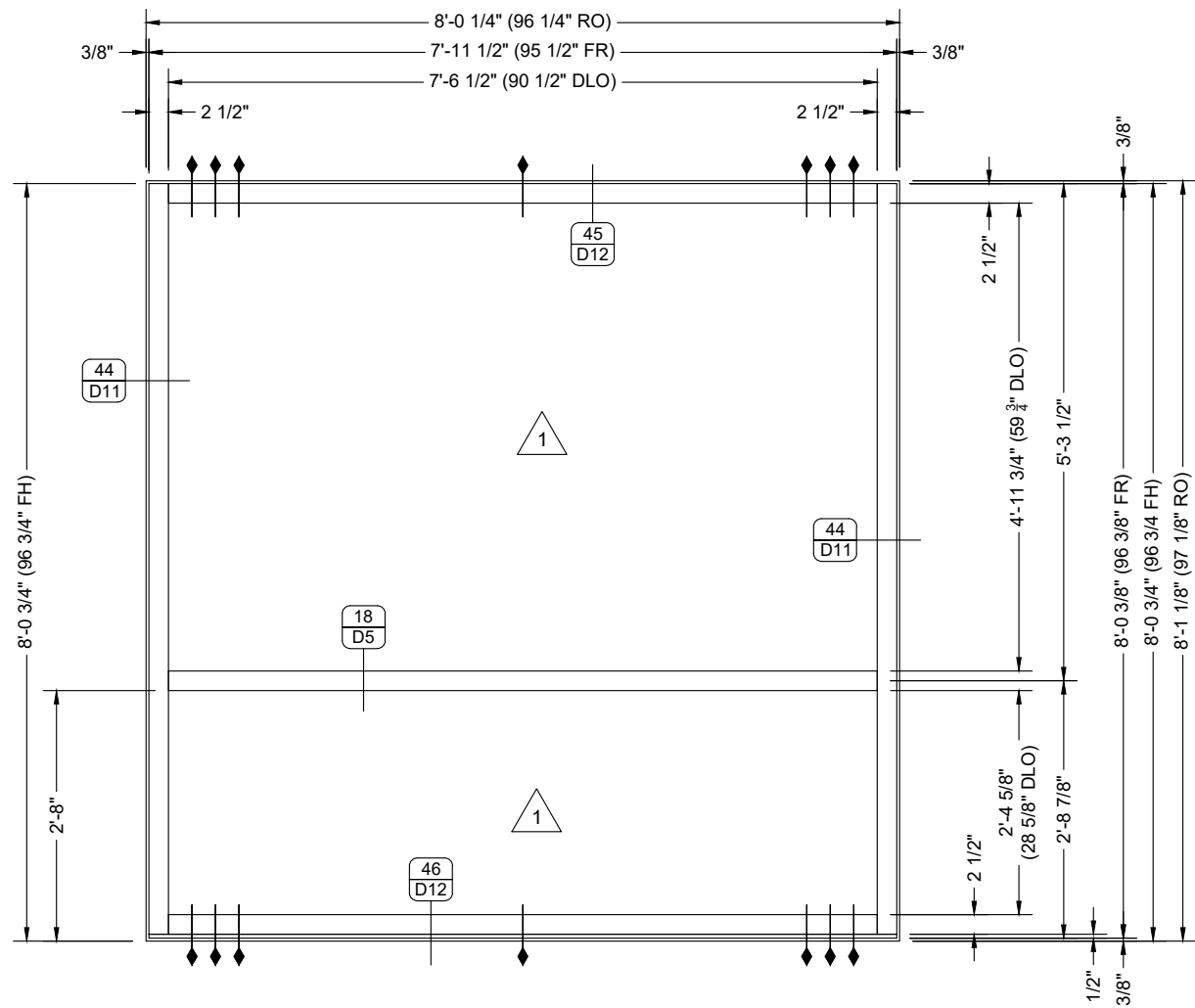

ELEVATION

QUANTITY: 01
 SCALE: 1/2" = 1'-0"
 ARCH REF: 1/SH4
 4/SH5



EXT STOREFRONT

KAWNEER IR-501 IMPACT ALUMINUM STOREFRONT

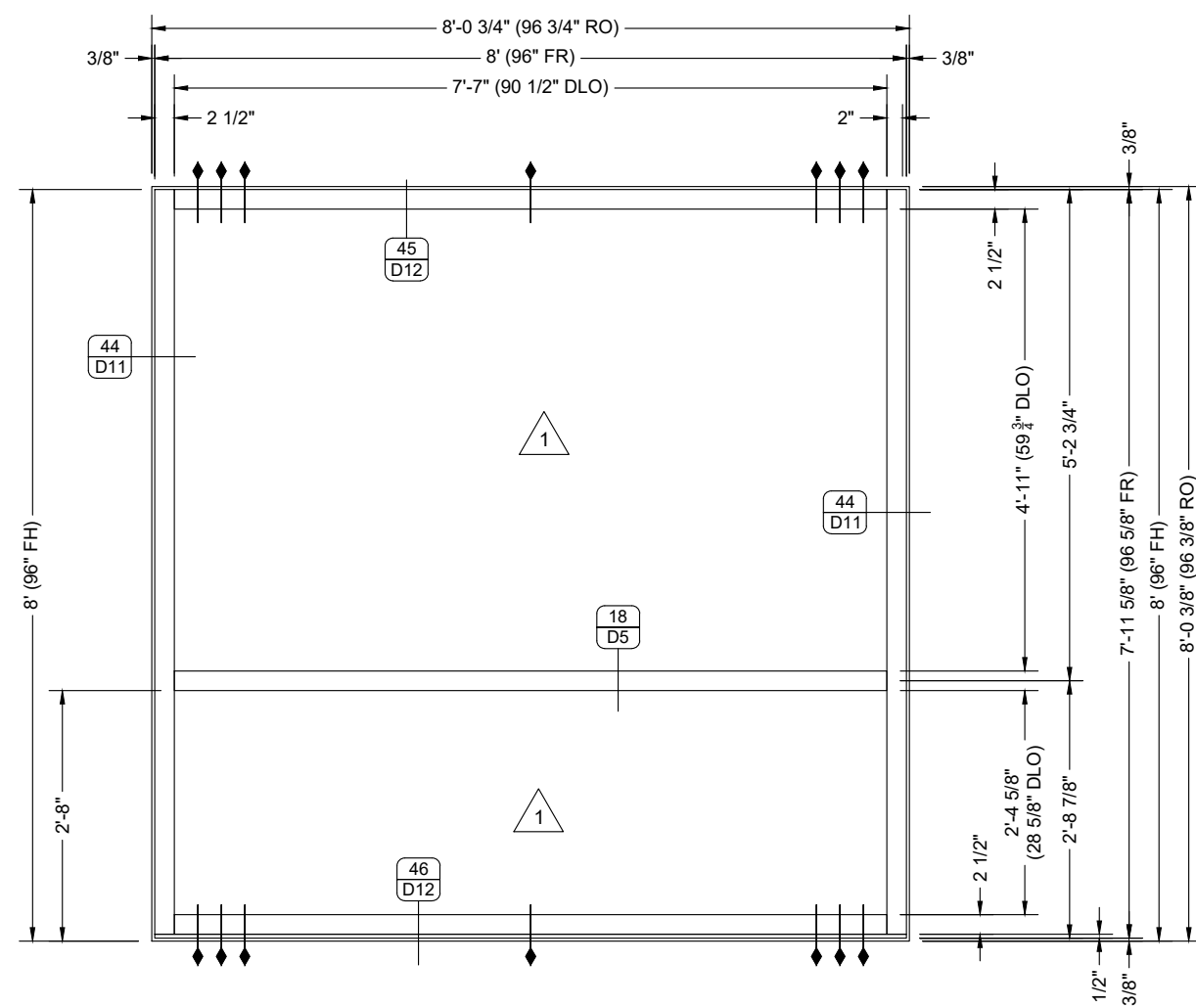

ELEVATION

QUANTITY: 01
 SCALE: 1/2" = 1'-0"
 ARCH REF: 1/SH4
 4/SH5



EXT STOREFRONT

KAWNEER IR-501 IMPACT ALUMINUM STOREFRONT

NO.	DATE	DESCRIPTION
1	05/09/22	First Submittal
1	fp	DATE
1	fp	DATE

EVINS GLASS SERVICE, INC
 101 N.P.I.D., CORPUS CHRISTI, TX 78406
 WORK (361) 884-3995 FAX (361) 884-4262

PROJECT: ART MUSEUM OF SOUTH TEXAS
RENOVATION IMPROVEMENTS
 ARCHITECT: HANSON PROFESSIONAL SERVICES, INC
 (361) 914-9800
 GENERAL CONTRACTOR: SOUTH TEXAS BUILDING PARTNERS
 (889) 298-5462

PROJECT NO. EGS-2204-05

DRAWN BY: fp DATE: 05/09/22

SCALE: 1/2" = 1'-0"

DRAWING: ELEVATIONS

SHEET: E6

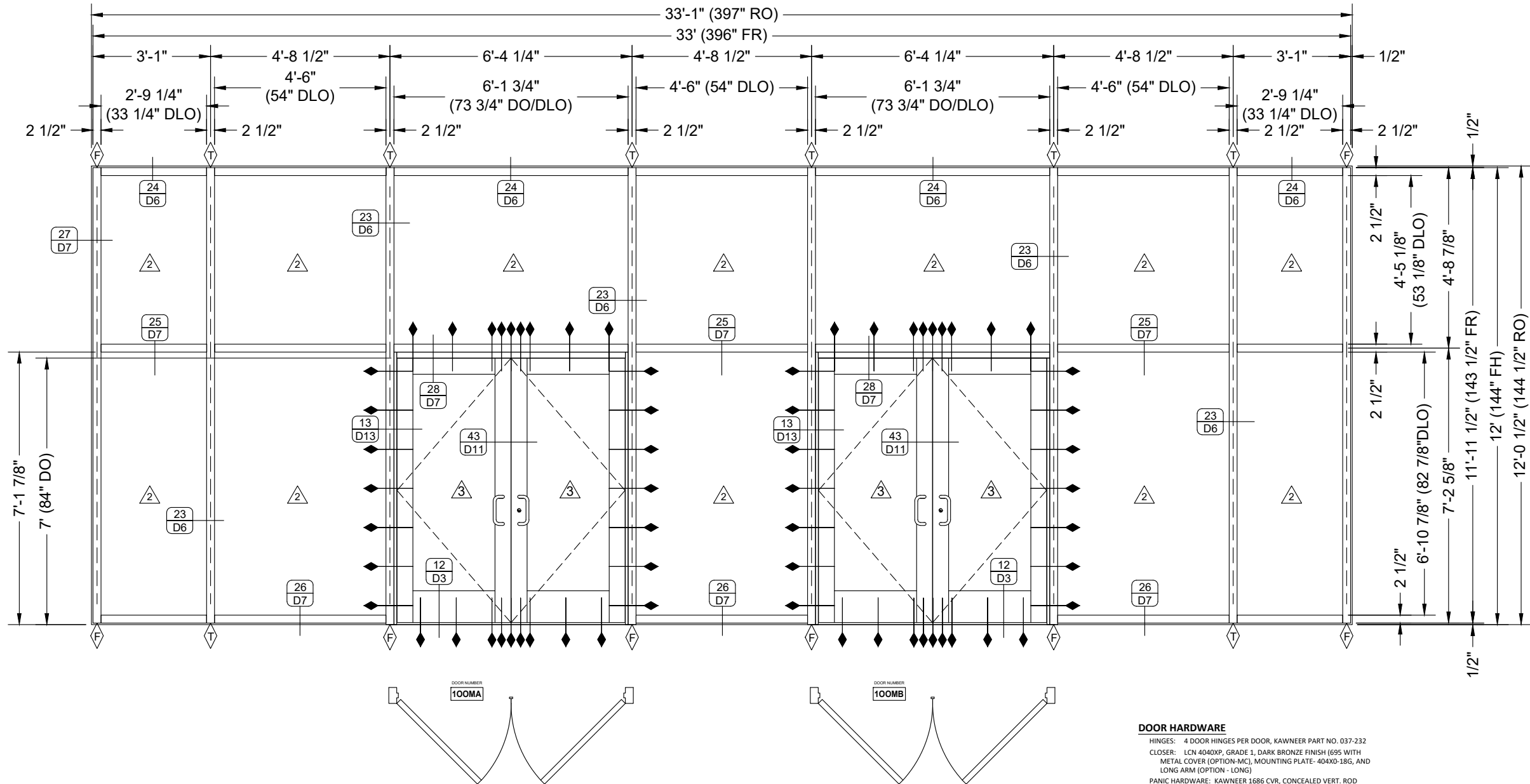

ELEVATION

QUANTITY: 01
 SCALE: 5/16" = 1'-0"
 ARCH REF: 1/SH6
 1/SH7
 1/SH11

1M

CURTAIN WALL

KAWNEER 1600, SYSTEM 1, CURTAIN WALL
 KAWNEER 500-1R DOORS ON 1600, SYS 1, CURTAIN WALL FRAME

TYPE "A"

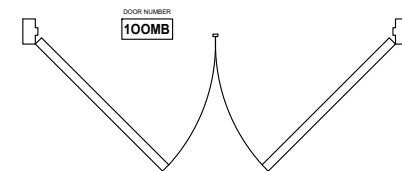
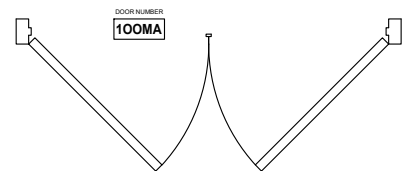

DOOR HARDWARE

HINGES: 4 DOOR HINGES PER DOOR, KAWNEER PART NO. 037-232
 CLOSER: LCN 4040XP, GRADE 1, DARK BRONZE FINISH (695 WITH METAL COVER (OPTION-MC), MOUNTING PLATE- 4040-18G, AND LONG ARM (OPTION - LONG)
 PANIC HARDWARE: KAWNEER 1686 CVR, CONCEALED VERT. ROD DEVICE, FINISH IN DARK BRONZE (710), WITH TOP STRIKE -338 AND BOTTOM STRIKE -358A
 a. LEFT LEAF TO HAVE FUNCTION - NLOP (NIGHT LATCH, LESS PULL) WITH 392-7 OFFSET PULL
 b. RIGHT LEAF TO HAVE FUNCTION - EO (EXIT ONLY) WITH 392-7 OFFSET PULL
 a.a. NOTE: PANIC HARDWARE CAN BE DOGGED (LOCKED DOWN IN THE OPEN POSITION) FROM THE INSIDE TO ALLOW FREE PASSAGE DURING OPERATING HOURS
 THRESHOLD: KAWNEER PART NO. 069-139, ALUMINUM
 BOTTOM RAIL WEATHER STRIP: KAWNEER PART NO. 200-795
 ASTRAGAL WEATHER GASKET - PER DOOR MANUFACTURER

NO.	DATE	BY	DESCRIPTION
1	05/09/22	fp	First Submittal

EVINS GLASS SERVICE, INC
 101 N.P.I.D., CORPUS CHRISTI, TX 78406
 WORK (361) 884-3995 FAX (361) 884-4262

PROJECT: ART MUSEUM OF SOUTH TEXAS
RENOVATION IMPROVEMENTS
 ARCHITECT: HANSON PROFESSIONAL SERVICES, INC
 (361) 914-9800
 GENERAL CONTRACTOR: SOUTH TEXAS BUILDING PARTNERS
 (889) 298-6462

PROJECT NO.	EGS-2204-05
DRAWN BY	fp
DATE	05/09/22
SCALE	5/16" = 1'-0"
DRAWING	ELEVATIONS
SHEET	E7

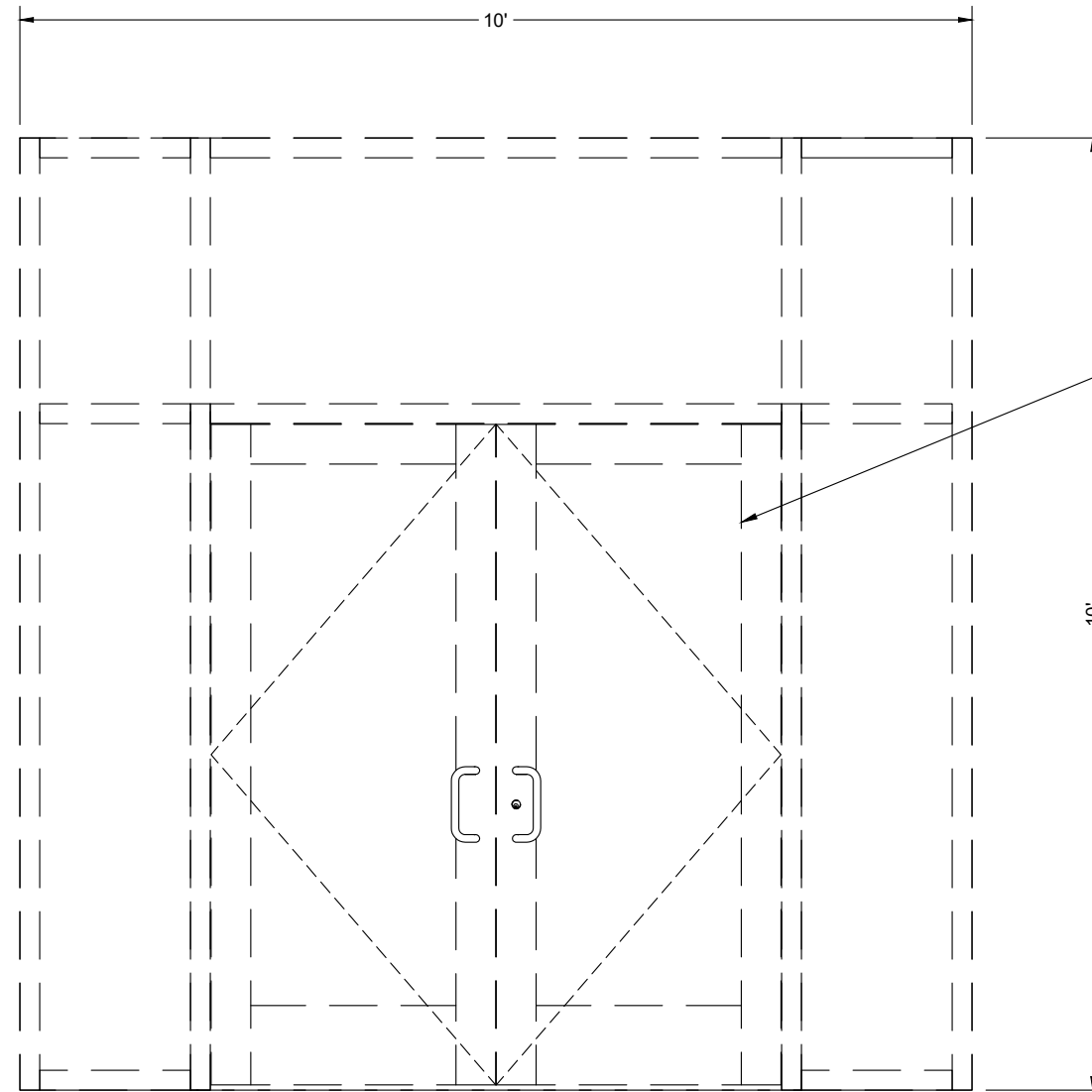

EXISTING 10'-0" X 10'-0" WIDE STOREFRONT WITH DOUBLE 3'-0" DOORS. REPAIR EXISTING DOUBLE DOORS ONLY.

ELEVATION

QUANTITY: 01
 SCALE: 1/2" = 1'-0"
 ARCH REF: 3/SH6
 6/SH7

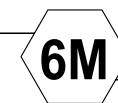

REPAIR STOREFRONT

REPAIR ONLY

SUB		BY	DATE	DESCRIPTION
1	fp	05/09/22	First Submittal	

EVINS GLASS SERVICE, INC
 101 N.P.I.D., CORPUS CHRISTI, TX 78406
 WORK (361) 884-3995 FAX (361) 884-4262

PROJECT: ART MUSEUM OF SOUTH TEXAS
RENOVATION IMPROVEMENTS
 ARCHITECT: HANSON PROFESSIONAL SERVICES, INC
 (361) 914-9800
 GENERAL CONTRACTOR: SOUTH TEXAS BUILDING PARTNERS
 (361) 298-5662

PROJECT NO. EGS-2204-05	
DRAWN BY fp	DATE 05/09/22
SCALE 1/2" = 1'-0"	
DRAWING ELEVATIONS	
SHEET E8	

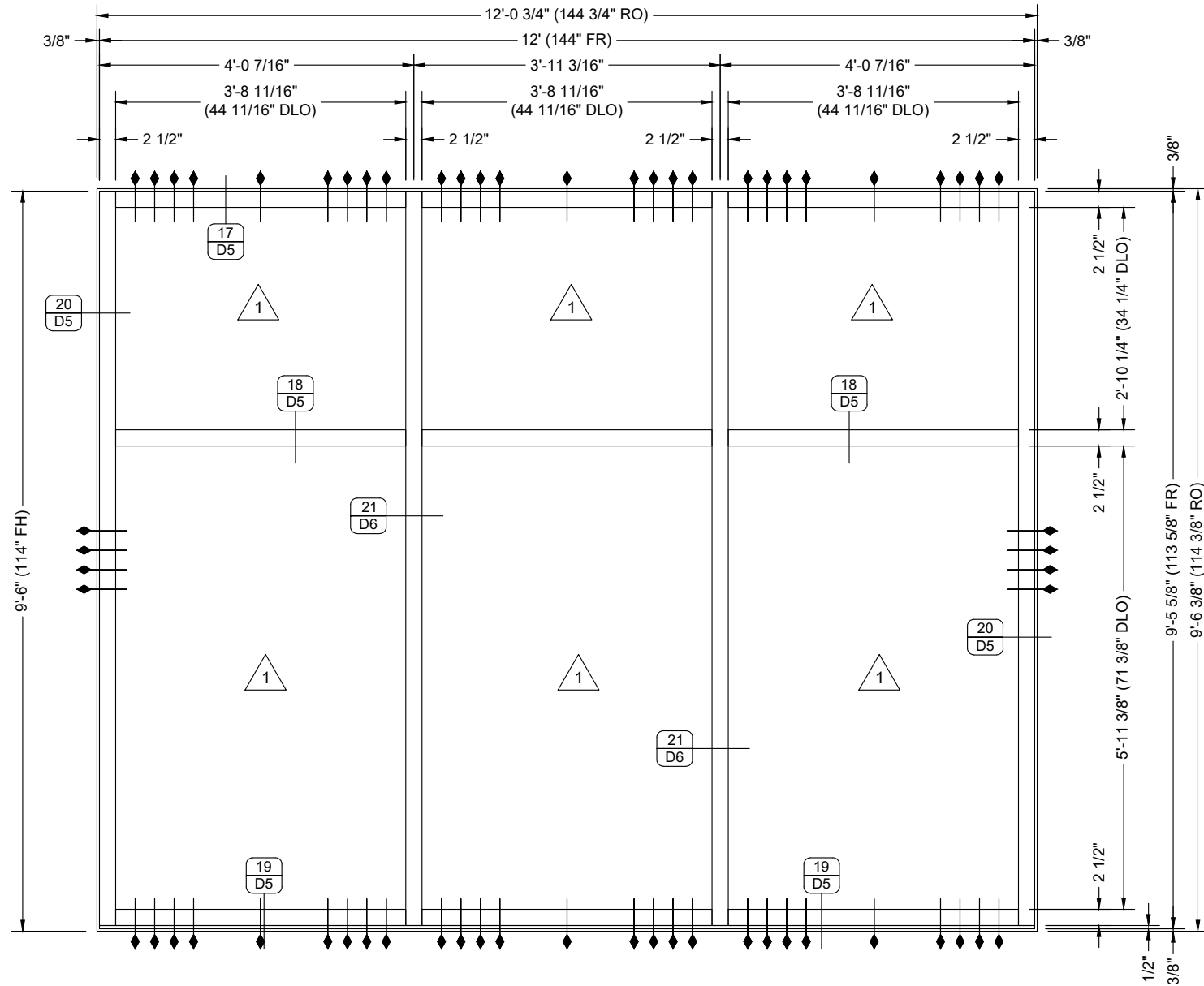
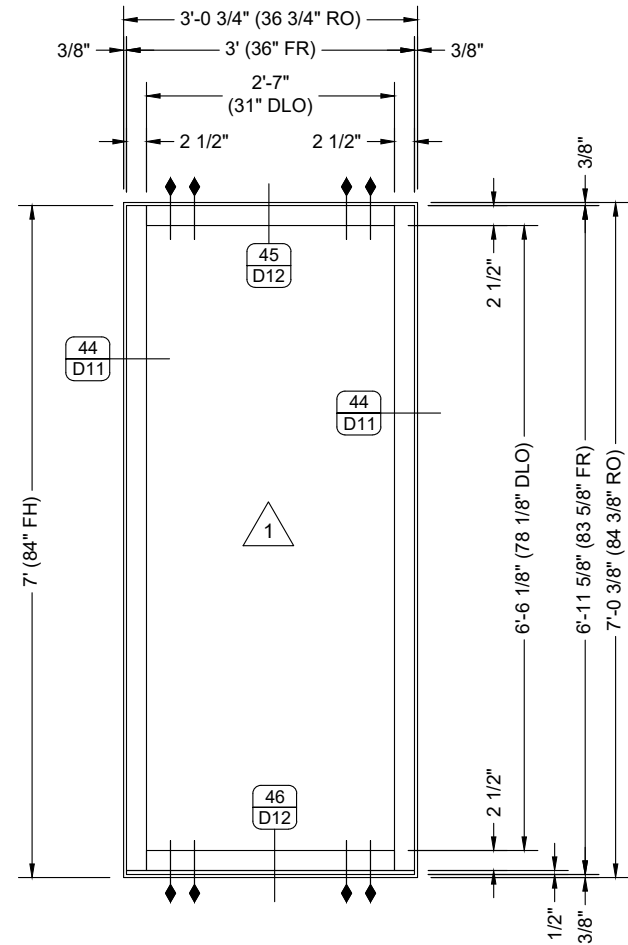

ELEVATION

QUANTITY: 01
 SCALE: 1/2" = 1'-0"
 ARCH REF: 4/SH6
 9/SH7



9M EXT STOREFRONT

KAWNEER IR-501 IMPACT ALUMINUM STOREFRONT

ELEVATION

QUANTITY: 03
 SCALE: 1/2" = 1'-0"
 ARCH REF: 1/SH6
 1/SH8
 2/SH8
 2/SH11



10M EXT STOREFRONT

KAWNEER IR-501 IMPACT ALUMINUM STOREFRONT

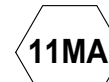

DATE	DESCRIPTION
05/09/22	First Submittal
fp	BY
1	SUB

EVINS GLASS SERVICE, INC

101 N.P.I.D., CORPUS CHRISTI, TX 78406
 WORK (361) 884-3995 FAX (361) 884-4262

PROJECT: ART MUSEUM OF SOUTH TEXAS
RENOVATION IMPROVEMENTS
 ARCHITECT: HANSON PROFESSIONAL SERVICES, INC
 (361) 914-9600
 GENERAL CONTRACTOR: SOUTH TEXAS BUILDING PARTNERS
 (361) 298-5462

PROJECT NO. EGS-2204-05	
DRAWN BY	DATE
fp	05/09/22
SCALE 1/2" = 1'-0"	
DRAWING ELEVATIONS	
SHEET E9	

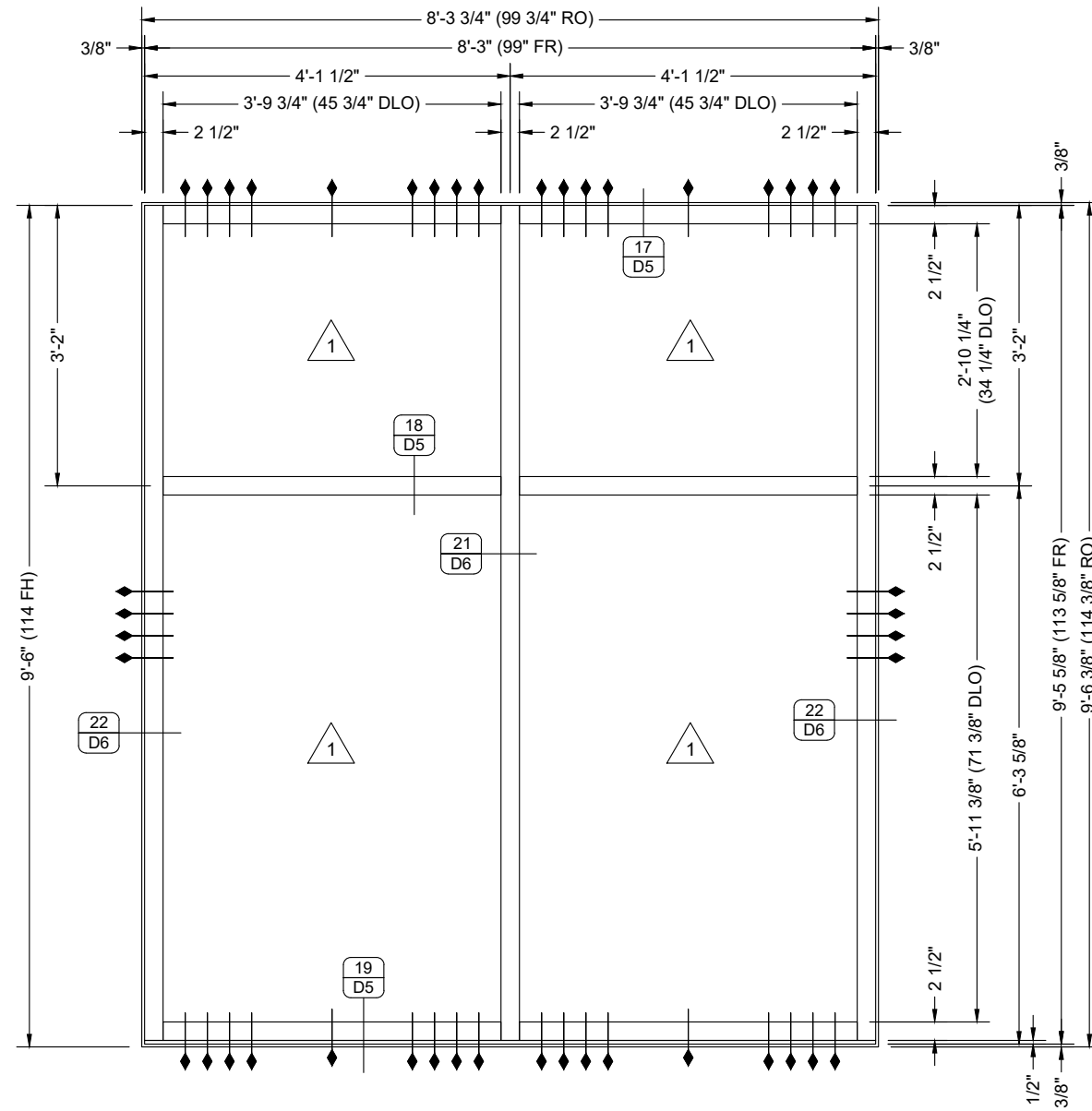

ELEVATION

QUANTITY: 01
 SCALE: 1/2" = 1'-0"
 ARCH REF: 1/SH6
 6/SH7
 3/SH8
 3/SH11

12M EXT STOREFRONT TYPE "C"
 KAWNEER IR-501 IMPACT ALUMINUM STOREFRONT

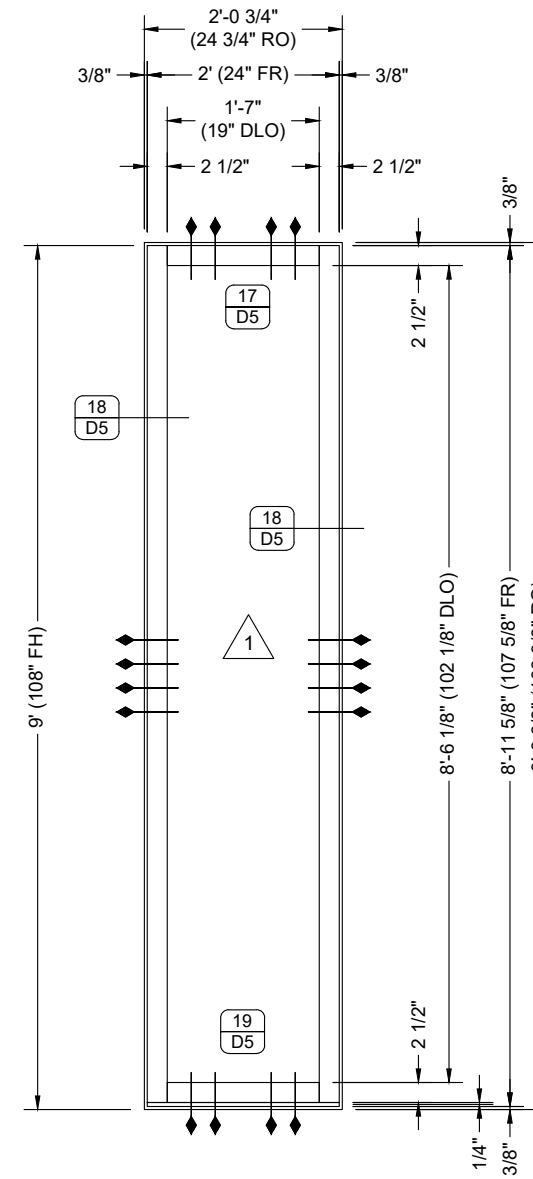

ELEVATION

QUANTITY: 01
 SCALE: 1/2" = 1'-0"
 ARCH REF: 1/SH6
 4/SH8
 4/SH11

13M EXT STOREFRONT TYPE "D"
 KAWNEER IR-501 IMPACT ALUMINUM STOREFRONT

NO.	DATE	BY	DESCRIPTION
1	05/09/22	fp	First Submittal

EVINS GLASS SERVICE, INC
 101 N.P.I.D., CORPUS CHRISTI, TX 78406
 WORK (361) 884-3995 FAX (361) 884-4262

PROJECT: ART MUSEUM OF SOUTH TEXAS
RENOVATION IMPROVEMENTS
 ARCHITECT: HANSON PROFESSIONAL SERVICES, INC
 (361) 914-9800
 GENERAL CONTRACTOR: SOUTH TEXAS BUILDING PARTNERS
 (889) 298-5462

PROJECT NO.	EGS-2204-05
DRAWN BY	fp
DATE	05/09/22
SCALE	1/2" = 1'-0"
DRAWING	ELEVATIONS
SHEET	E10

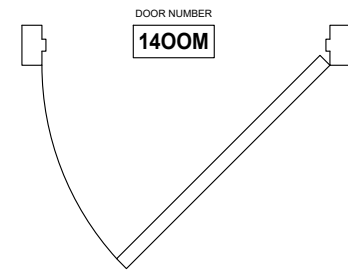
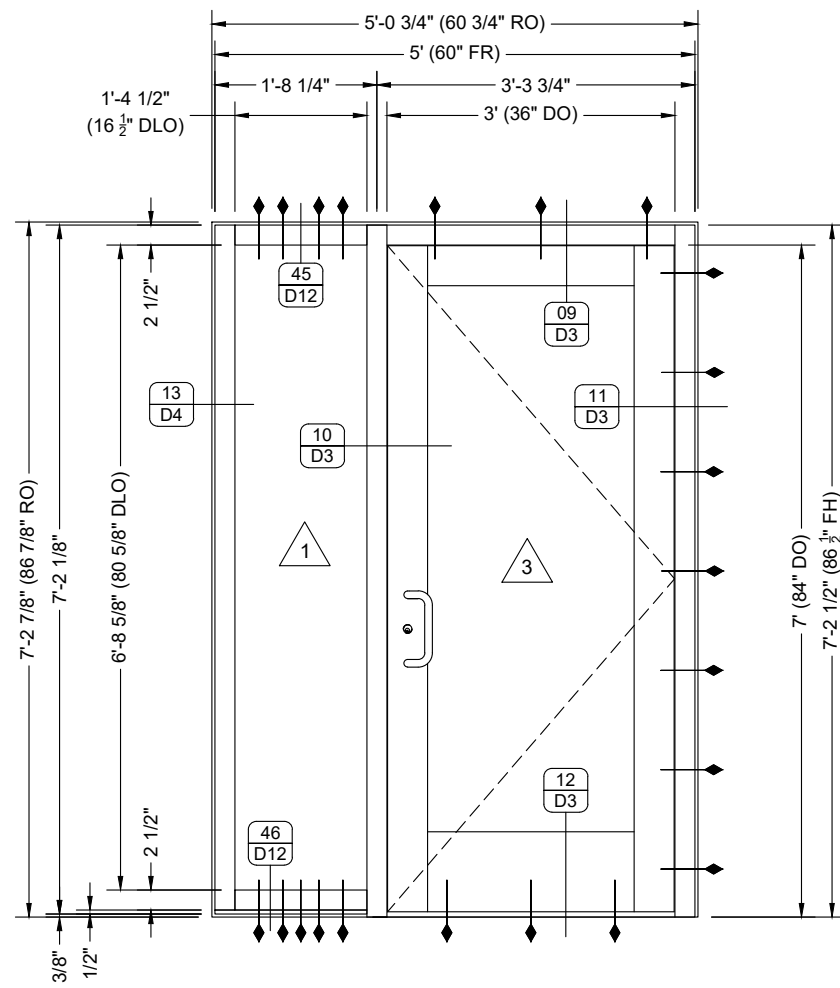

DOOR HARDWARE

- HINGES: 4 PER DOOR, KAWNEER PART NO. 037-232
 CLOSER: LCN 4040XP, GRADE 1, DARK BRONZE FINISH (695 WITH METAL COVER (OPTION-MC), MOUNTING PLATE- 404X0-18G, AND LONG ARM (OPTION - LONG)
 PANIC HARDWARE: KAWNEER 1686 CVR, CONCEALED VERT. ROD DEVICE, FINISH IN DARK BRONZE (710), WITH TOP STRIKE -338 AND BOTTOM STRIKE -358A
- a. LEFT LEAF TO HAVE FUNCTION - NLOP (NIGHT LATCH, LESS PULL) WITH 392-7 OFFSET PULL
 - b. RIGHT LEAF TO HAVE FUNCTION - EO (EXIT ONLY) WITH 392-7 OFFSET PULL
 - a.a. NOTE: PANIC HARDWARE CAN BE DOGGED (LOCKED DOWN IN THE OPEN POSITION) FROM THE INSIDE TO ALLOW FREE PASSAGE DURING OPERATING HOURS
- THRESHOLD: KAWNEER PART NO. 069-139, ALUMINUM
 BOTTOM RAIL WEATHER STRIP: KAWNEER PART NO. 200-795
 ASTRAGAL WEATHER GASKET - PER DOOR MANUFACTURER

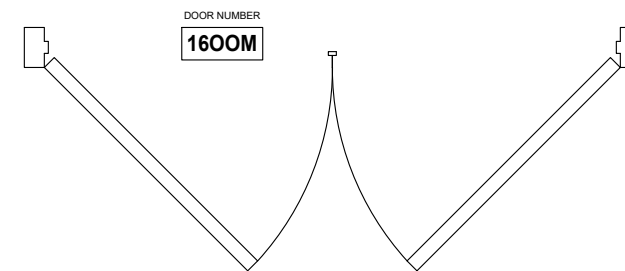
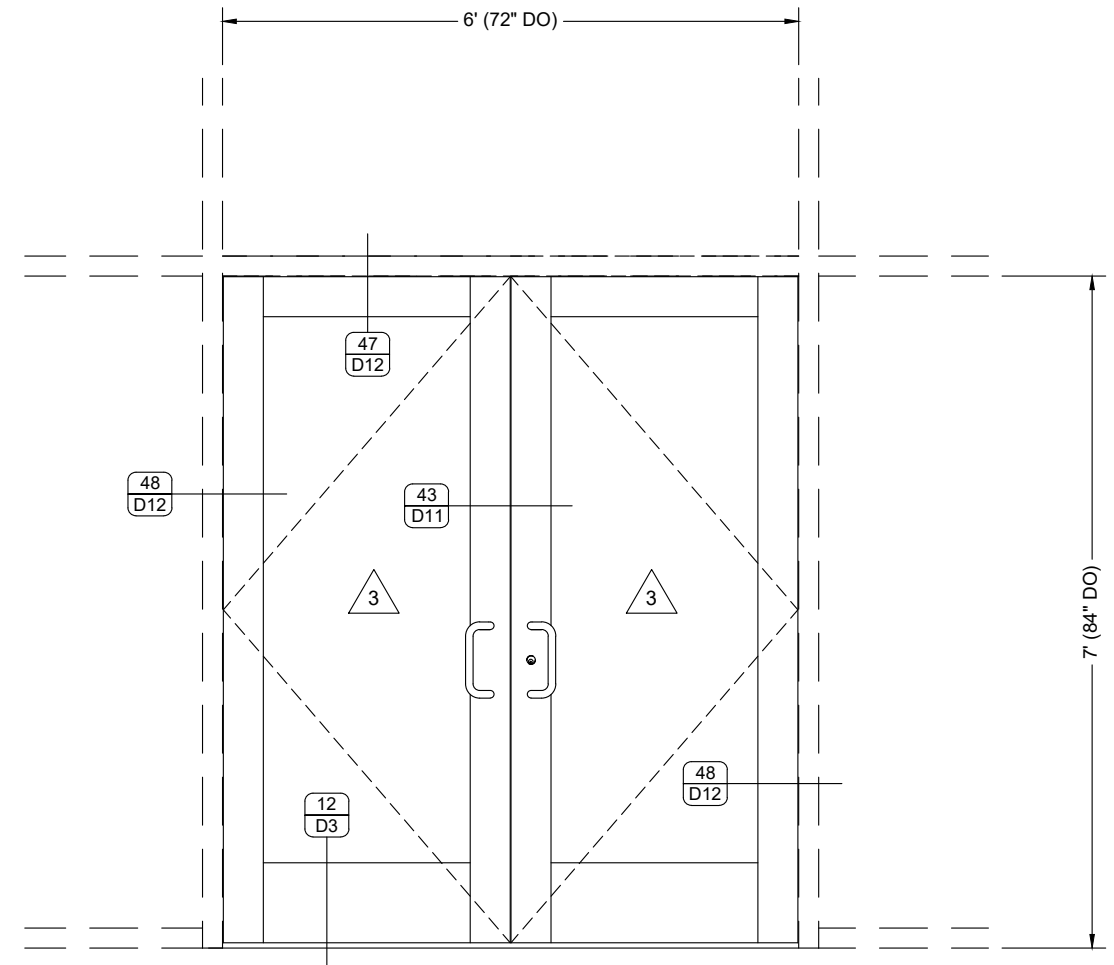

ELEVATION

QUANTITY: 01
 SCALE: 1/2" = 1'-0"
 ARCH REF: 4/SH6
 5/SH8
 2/SH10

14M

EXT STOREFRONT TYPE "2/ SHEET10"

KAWNEER IR-501 IMPACT ALUMINUM STOREFRONT
 KAWNEER 500-IR IMPACT DOORS ON IR-501 FRAMING

ELEVATION

QUANTITY: 01
 SCALE: 1/2" = 1'-0"
 ARCH REF: 1/SH6
 7/SH8

16M

REPLACE DOORS

KAWNEER 500-IR IMPACT DOORS ON EXISTING FRAME

NO.	DATE	BY	DESCRIPTION
1	05/09/22	fp	First Submittal

EVINS GLASS SERVICE, INC
 101 N.P.I.D., CORPUS CHRISTI, TX 78406
 WORK (361) 884-3995 FAX (361) 884-4262

PROJECT: ART MUSEUM OF SOUTH TEXAS
RENOVATION IMPROVEMENTS
 ARCHITECT: HANSON PROFESSIONAL SERVICES, INC (361) 914-9800
 GENERAL CONTRACTOR: SOUTH TEXAS BUILDING PARTNERS (361) 298-5462

PROJECT NO.	EGS-2204-05
DRAWN BY	fp
DATE	05/09/22
SCALE	1/2" = 1'-0"
DRAWING	ELEVATIONS
SHEET	E11

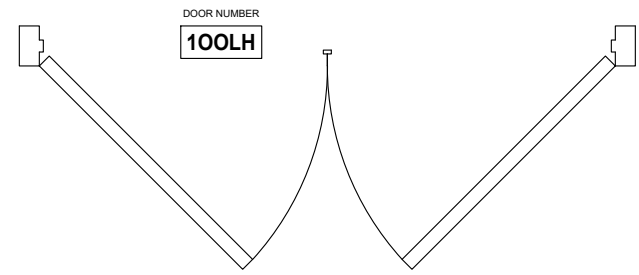
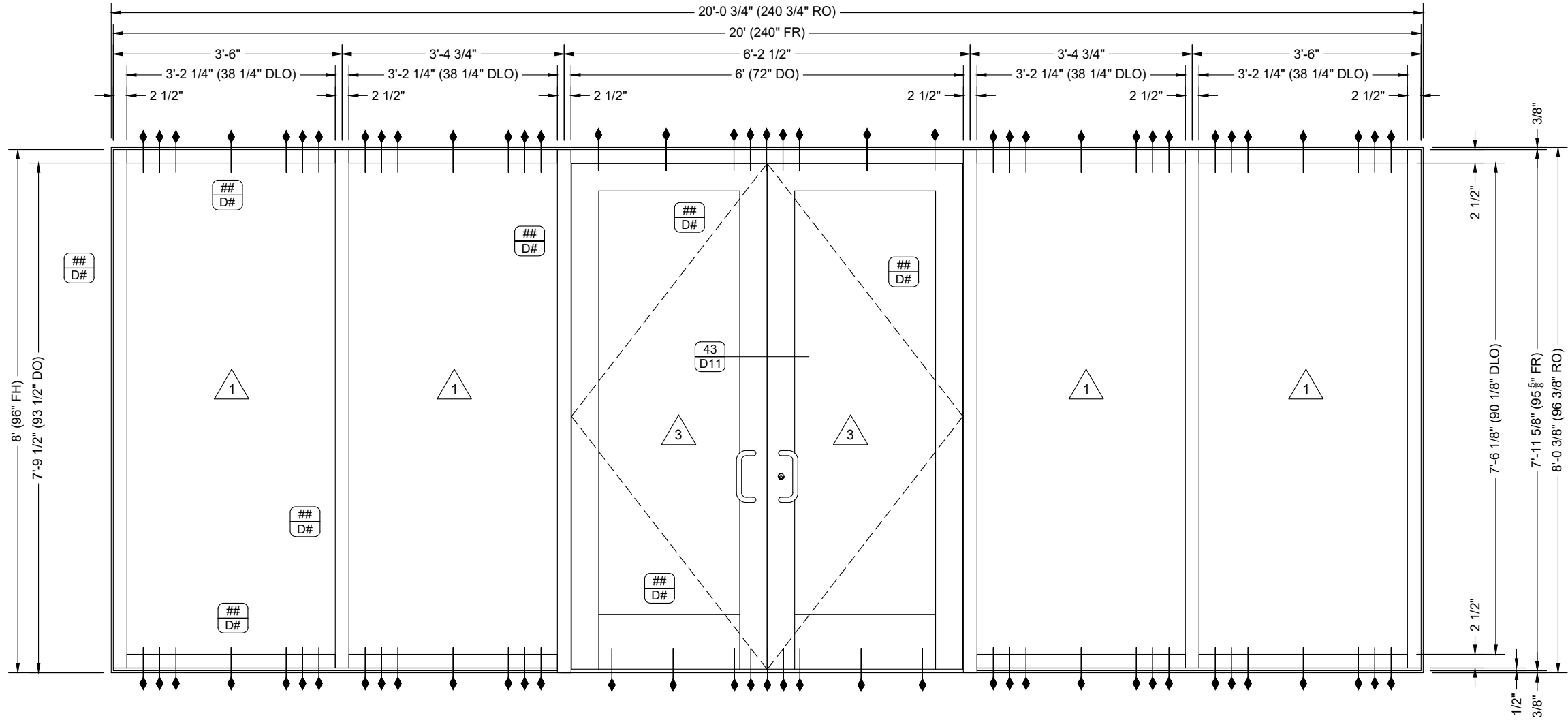

DOOR HARDWARE

- HINGES: 4 DOOR HINGES PER DOOR, KAWNEER PART NO. 037-232
- CLOSER: LCN 4040XP, GRADE 1, DARK BRONZE FINISH (695 WITH METAL COVER (OPTION-MC), MOUNTING PLATE- 404X0-18G, AND LONG ARM (OPTION - LONG)
- PANIC HARDWARE: KAWNEER 1686 CVR, CONCEALED VERT. ROD DEVICE, FINISH IN DARK BRONZE (710), WITH TOP STRIKE -338 AND BOTTOM STRIKE -358A
 - a. LEFT LEAF TO HAVE FUNCTION - NLOP (NIGHT LATCH, LESS PULL) WITH 392-7 OFFSET PULL
 - b. RIGHT LEAF TO HAVE FUNCTION - EO (EXIT ONLY) WITH 392-7 OFFSET PULL
 - a.a. NOTE: PANIC HARDWARE CAN BE DOGGED (LOCKED DOWN IN THE OPEN POSITION) FROM THE INSIDE TO ALLOW FREE PASSAGE DURING OPERATING HOURS
- THRESHOLD: KAWNEER PART NO. 069-139, ALUMINUM
- BOTTOM RAIL WEATHER STRIP: KAWNEER PART NO. 200-795
- ASTRAGAL WEATHER GASKET - PER DOOR MANUFACTURER

ELEVATION

QUANTITY: 01
 SCALE: 1/2" = 1'-0"
 ARCH REF: 1/SH9

1LH

EXT STOREFRONT TYPE "K"

KAWNEER IR-501 IMPACT ALUMINUM STOREFRONT
 KAWNEER 500-IR IMPACT DOORS ON IR-501 FRAMING

SUBMITTAL		DESCRIPTION
DATE	BY	
05/09/22	fp	First Submittal

EVINS GLASS SERVICE, INC
 101 N.P.I.D., CORPUS CHRISTI, TX 78406
 WORK (361) 884-3995 FAX (361) 884-4262

PROJECT: ART MUSEUM OF SOUTH TEXAS
RENOVATION IMPROVEMENTS
 ARCHITECT: HANSON PROFESSIONAL SERVICES, INC
 (861) 914-9800
 GENERAL CONTRACTOR: SOUTH TEXAS BUILDING PARTNERS
 (861) 298-5462

PROJECT NO.	EGS-2204-05
DRAWN BY	fp
DATE	05/09/22
SCALE	1/2" = 1'-0"
DRAWING	ELEVATIONS
SHEET	E12

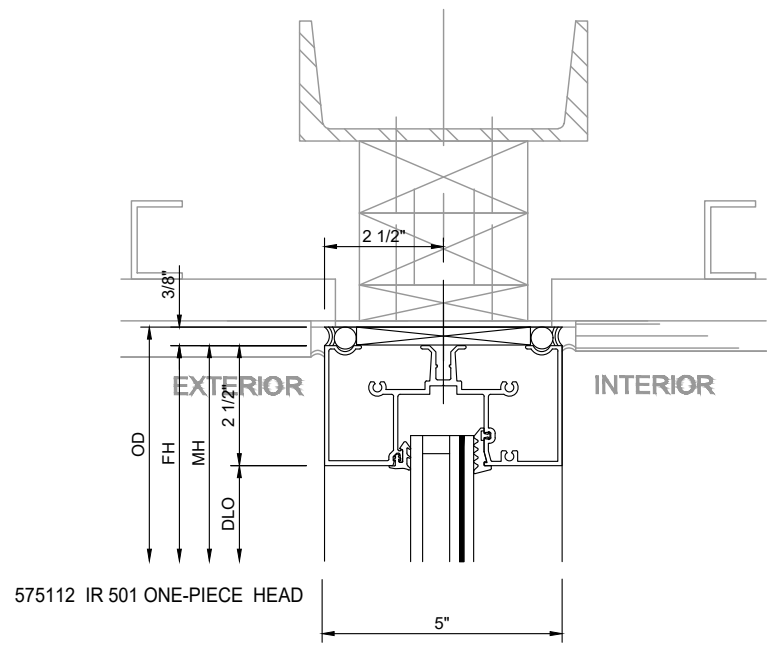

575112 IR 501 ONE-PIECE HEAD

DETAIL

01

STOREFRONT HEAD

KAWNEER IR-501 IMPACT ALUMINUM STOREFRONT

SCALE: 3" = 1'-0"

ARCH REF: 2/ SHEET 9

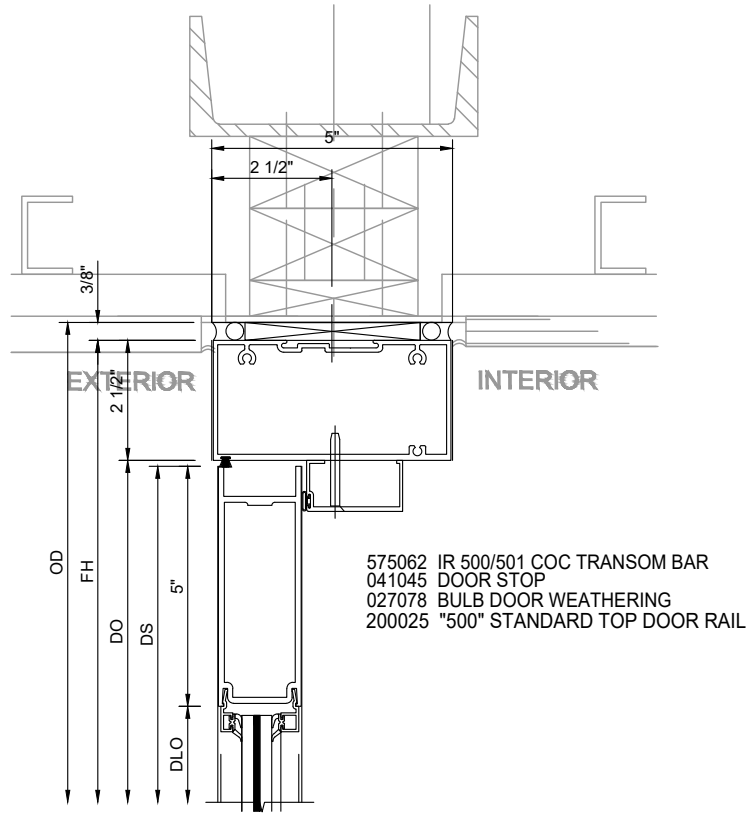

575062 IR 500/501 COC TRANSOM BAR
 041045 DOOR STOP
 027078 BULB DOOR WEATHERING
 200025 "500" STANDARD TOP DOOR RAIL

DETAIL

03

STOREFRONT DOOR HEADER

KAWNEER IR-501 IMPACT ALUMINUM STOREFRONT
 KAWNEER 500-IR IMPACT WIDE STILE ENTRANCE DOORS

SCALE: 3" = 1'-0"

ARCH REF: 4/ SHEET 9

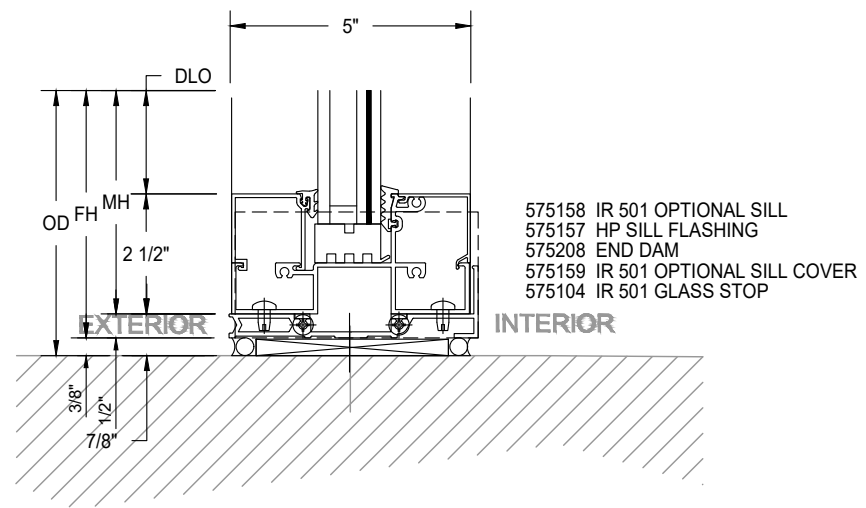

575158 IR 501 OPTIONAL SILL
 575157 HP SILL FLASHING
 575208 END DAM
 575159 IR 501 OPTIONAL SILL COVER
 575104 IR 501 GLASS STOP

DETAIL

02

STOREFRONT SILL

KAWNEER IR-501 IMPACT ALUMINUM STOREFRONT

SCALE: 3" = 1'-0"

ARCH REF: 3/ SHEET 9

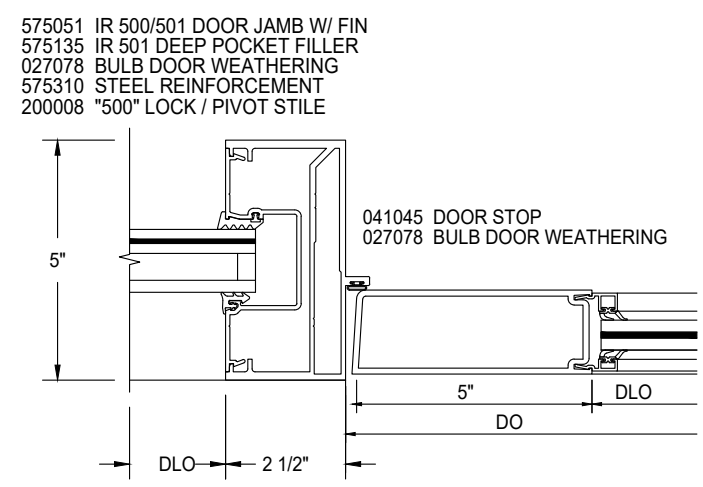

575051 IR 500/501 DOOR JAMB W/ FIN
 575135 IR 501 DEEP POCKET FILLER
 027078 BULB DOOR WEATHERING
 575310 STEEL REINFORCEMENT
 200008 "500" LOCK / PIVOT STILE

041045 DOOR STOP
 027078 BULB DOOR WEATHERING

DETAIL

04

STOREFRONT STRIKE JAMB W/ SIDELITE

KAWNEER IR-501 IMPACT ALUMINUM STOREFRONT
 KAWNEER 500-IR IMPACT WIDE STILE ENTRANCE DOORS

SCALE: 3" = 1'-0"

ARCH REF: 5/ SHEET 9

NO.	DATE	DESCRIPTION
1	05/09/22	First Submittal
1		fp
		BY
		DATE
		DESCRIPTION

EVINS GLASS SERVICE, INC
 101 N.P.I.D., CORPUS CHRISTI, TX 78406
 WORK (361) 884-3995 FAX (361) 884-4262

PROJECT: ART MUSEUM OF SOUTH TEXAS
RENOVATION IMPROVEMENTS
 ARCHITECT: HANSON PROFESSIONAL SERVICES, INC
 (361) 914-9800
 GENERAL CONTRACTOR: SOUTH TEXAS BUILDING PARTNERS
 (361) 298-6462

PROJECT NO.	EGS-2204-05
DRAWN BY	fp
DATE	05/09/22
SCALE	3" = 1'-0"
DRAWING	DETAILS
SHEET	D1